

2023 Property Records for Town of Rhine, Sheboygan County

July 27, 2023

Tax key number: 59018259571

Property address: N7329 Highview Rd

Traffic / water / sanitary: Medium / Well Water / Septic

Legal description: LOT 1,CSM V 8 P 43 - PRT SW SW,SEC 33,COM S89 DEG 26' 18"E 172.30'FROM SW COR SD SEC,TH N02 DEG 21'04"E 478.35',N89 DEG 26'18"W 188.74'TO CENLN GOLF COURSE RD,NELY 83.12'ALG CURVE,S83 DEG 29'50"E 612.69'TO WLY R/W CMSTP&P RR,SWLY ALG R/W510.28',TH N89 ...

Summary of Assessment	
Land	\$51,000
Improvements	\$194,200
Total value	\$245,200

Land									
Qty	Land Use	Width	Depth	Square Feet	Acres	Water Frontage	Tax Class	Special Tax Program	Assess Value
1	Residential			217,800	5.000	None	Residential		\$51,000

Residential Building			
Year built:	1987	Full basement:	2,116 SF
Year remodeled:	2001	Crawl space:	
Stories:	1 story	Rec room (rating):	
Style:	Modular Home	Fin bsmt living area:	
Use:	Single family	First floor:	2,116 SF
Exterior wall:	Vinyl	Second floor:	
Masonry adjust:	172 SF	Third floor:	
Roof type:	Asphalt Ave	Finished attic:	
Heating:	Gas, forced air	Unfinished attic:	
Cooling:	A/C, same ducts	Unfinished area:	
Bedrooms:	3	Patio	400 SF
Family rooms:		Deck	80 SF
Baths:	2 full, 0 half		
Other rooms:			
Whirl / hot tubs:	1 whirlpool, 0 hot		
Add'l plumb fixt:			
Masonry FPs:			
Metal FPs:			
Gas only FPs:	1 openings	Grade:	C-
Bsmt garage:	2	Condition:	Average
Shed dormers:		Energy adjustment:	No
Gable/hip dorm:		Percent complete:	100%



Total living area is 2,116 SF; building assessed value is \$159,500

259571

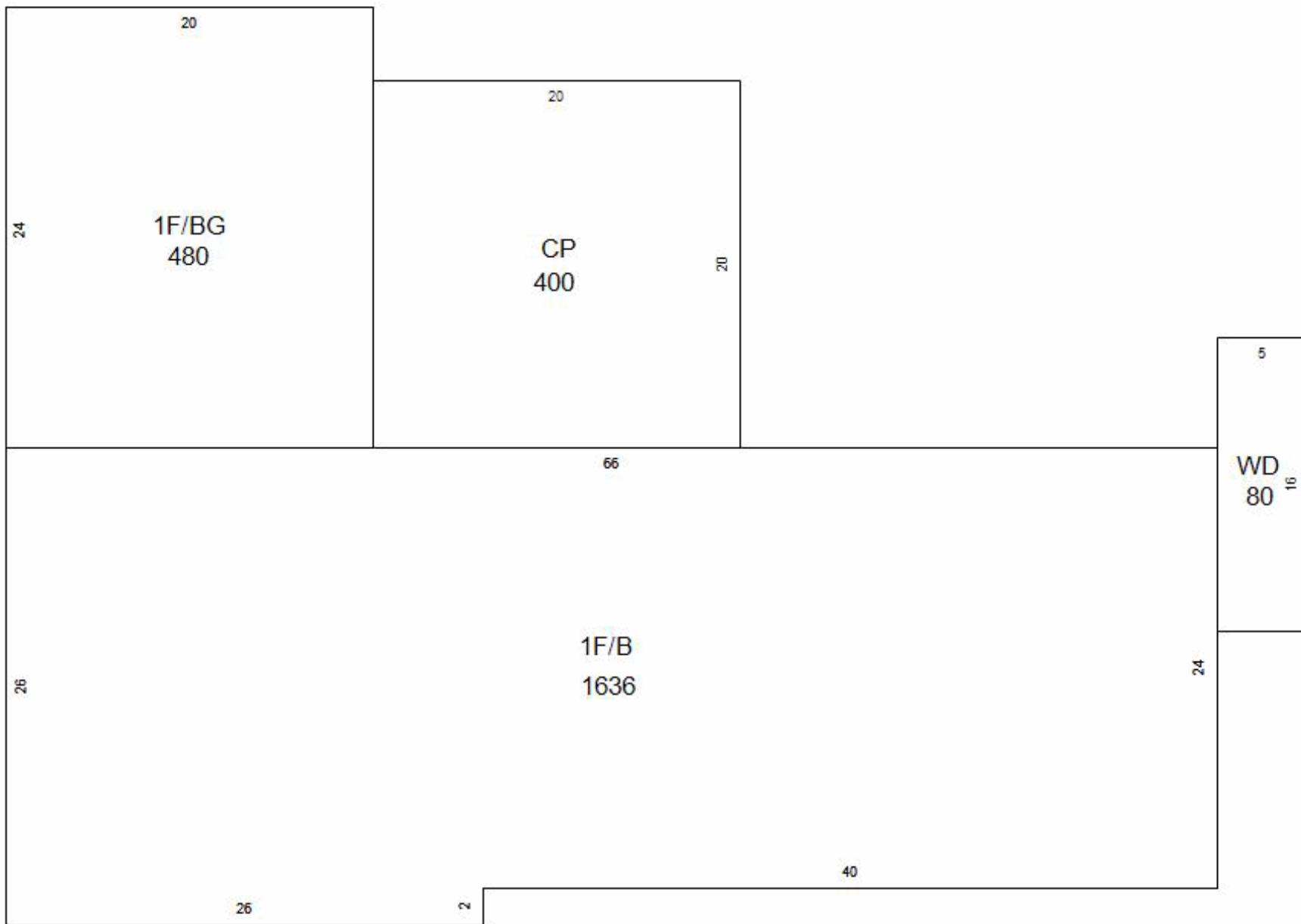

2023 Property Records for Town of Rhine, Sheboygan County

July 27, 2023

# of identical OBIs: 1		Other Building Improvement (OBI)		
Main Structure		Modifications (Type, Size)		Photograph
OBI type: Garage	Width: 36 LF	Grade: C		
Const type: Detached, pole frame	Depth: 60 LF	Condition: Average		
Year built: 1988	Floor area: 2,160 SF	% complete: 100%	Assessed \$: \$15,600	

# of identical OBIs: 1		Other Building Improvement (OBI)		
Main Structure		Modifications (Type, Size)		Photograph
OBI type: Garage	Width: 30 LF	Grade: C		
Const type: Detached, frame or cb	Depth: 24 LF	Condition: Average		
Year built: 1980	Floor area: 720 SF	% complete: 100%	Assessed \$: \$8,500	

# of identical OBIs: 1		Other Building Improvement (OBI)		
Main Structure		Modifications (Type, Size)		Photograph
OBI type: Garage	Width: 24 LF	Grade: C		
Const type: Detached, frame or cb	Depth: 24 LF	Condition: Average		
Year built: 1950	Floor area: 576 SF	% complete: 100%	Assessed \$: \$5,600	

Other Improvements		
Tax Class	Description	Assess Value
Residential	WS	\$5,000

Building Permits				
Issued	Permit #	Purpose	\$ Amount	Completed
4/12/2001	51	Additionl	\$55,000	12/31/2001

Sales History		
Date	Price	Type
5/27/2021	\$262,800	Not a market sale
4/1/2015	\$121,950	Not a market sale