

2023 Property Records for Town of Wilson, Sheboygan County

December 13, 2023

Tax key number: 59030463341

Property address: 9220 Middle Rd

Traffic / water / sanitary: Light / Well water / Septic

Summary of Assessment	
Land	\$74,500
Improvements	\$300,000
Total value	\$374,500

Land									
Qty	Land Use	Width	Depth	Square Feet	Acres	Water Frontage	Tax Class	Special Tax Program	Assess Value
1	Residential			217,800	5.000	None	Residential		\$74,500

Residential Building			
Year built: 1962	Full basement: 2,378 SF		
Year remodeled:	Crawl space:		
Stories: 1 story	Rec room (rating):		
Style: Ranch	Fin bsmt living area:		
Use: 2 Family	First floor: 2,378 SF		
Exterior wall: Brick	Second floor:		
Masonry adjust:	Third floor:		
Roof type: Asphalt shingles	Finished attic:		
Heating: Oil, hot water	Unfinished attic:		
Cooling: No A/C	Unfinished area:		
Bedrooms: 5	Open porch 50 SF		
Family rooms:	Open porch 50 SF		
Baths: 2 full, 0 half	Deck 140 SF		
Other rooms: 4			
Whirl / hot tubs:			
Add'l plumb fixt:			
Masonry FPs:			
Metal FPs:			
Gas only FPs:	Grade: C+		
Bsmt garage:	Condition: Average		
Shed dormers:	Energy adjustment: No		
Gable/hip dorm:	Percent complete: 100%		

Total living area is 2,378 SF; building assessed value is \$282,600

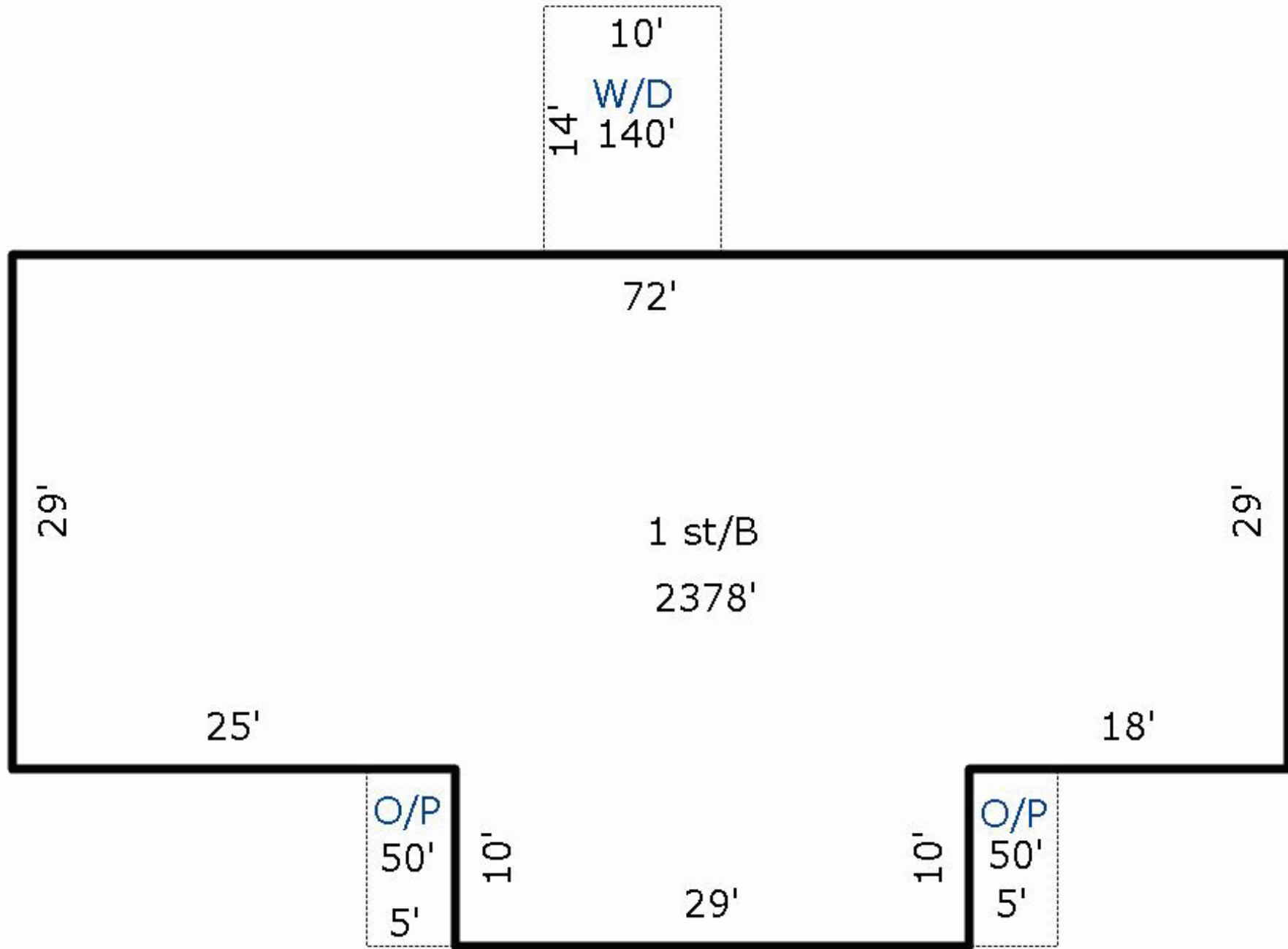

2023 Property Records for Town of Wilson, Sheboygan County

December 13, 2023

# of identical OBIs: 1		Other Building Improvement (OBI)		
Main Structure		Modifications (Type, Size)		Photograph
OBI type: Shed, farm implement equipme	Width: 40 LF	Grade: C		not available
Const type: Pole frame, metal siding	Depth: 80 LF	Condition: Average		
Year built: 1970	Floor area: 3,200 SF	% complete: 100%		
	Height: 10 LF	Assessed \$: \$12,200		

# of identical OBIs: 1		Other Building Improvement (OBI)		
Main Structure		Modifications (Type, Size)		Photograph
OBI type: Lean-to	Width: 10 LF	Grade: C		not available
Const type: Wood frame, wood siding	Depth: 48 LF	Condition: Average		
Year built: 1970	Floor area: 480 SF	% complete: 100%		
	Height: 8 LF	Assessed \$: \$800		

# of identical OBIs: 1		Other Building Improvement (OBI)		
Main Structure		Modifications (Type, Size)		Photograph
OBI type: Utility shed, residential	Width: 11 LF	Grade: C		not available
Const type: Frame	Depth: 11 LF	Condition: Average		
Year built: 1970	Floor area: 121 SF	% complete: 100%		
		Assessed \$: \$400		

# of identical OBIs: 1		Other Building Improvement (OBI)		
Main Structure		Modifications (Type, Size)		Photograph
OBI type: Utility shed, residential	Width: 14 LF	Grade: C		not available
Const type: Frame	Depth: 20 LF	Condition: Average		
Year built: 1990	Floor area: 280 SF	% complete: 100%		
		Assessed \$: \$800		

# of identical OBIs: 1		Other Building Improvement (OBI)		
Main Structure		Modifications (Type, Size)		Photograph
OBI type: Garage	Width: 18 LF	Grade: C		not available
Const type: Detached, frame or cb	Depth: 30 LF	Condition: Average		
Year built: 1950	Floor area: 540 SF	% complete: 100%		
		Assessed \$: \$3,200		