

2023 Property Records for Town of Lima, Sheboygan County

February 8, 2024

Tax key number: 59008094421

Property address: N4338 Claver Ct

Traffic / water / sanitary: Light / Well water / Septic

Legal description: LOT 1 CSM V26 P204-206 #1991349 - PRT SE NE, SEC 12.

Summary of Assessment	
Land	\$73,400
Improvements	\$270,000
Total value	\$343,400

Land									
Qty	Land Use	Width	Depth	Square Feet	Acres	Water Frontage	Tax Class	Special Tax Program	Assess Value
1	Residential			275,299	6.320	Pond (Prime)	Residential		\$72,100
1	1st grade tillable			217,800	5.000	None	1st grade tillable		\$1,300

Residential Building			
Year built:	1987	Full basement:	936 SF
Year remodeled:	1993	Crawl space:	624 SF
Stories:	1 story	Rec room (rating):	468 SF (AV)
Style:	Ranch	Fin bsmt living area:	
Use:	Single family	First floor:	1,560 SF
Exterior wall:	Alum/vinyl	Second floor:	
Masonry adjust:		Third floor:	
Roof type:	Asphalt shingles	Half story:	0 SF
Heating:	Gas, forced air	Finished attic:	
Cooling:	A/C, same ducts	Unfinished attic:	
Bedrooms:	3	Unfinished area:	
Family rooms:		Patio	264 SF
Baths:	2 full, 0 half	Enclosed porch	64 SF
Other rooms:		Free Standing Stove	1 units
Whirl / hot tubs:			
Add'l plumb fixt:		Grade:	C
Masonry FPs:		Condition:	Average
Metal FPs:		Percent complete:	100%
Gas only FPs:			
Bsmt garage:			
Shed dormers:			
Gable/hip dorm:			



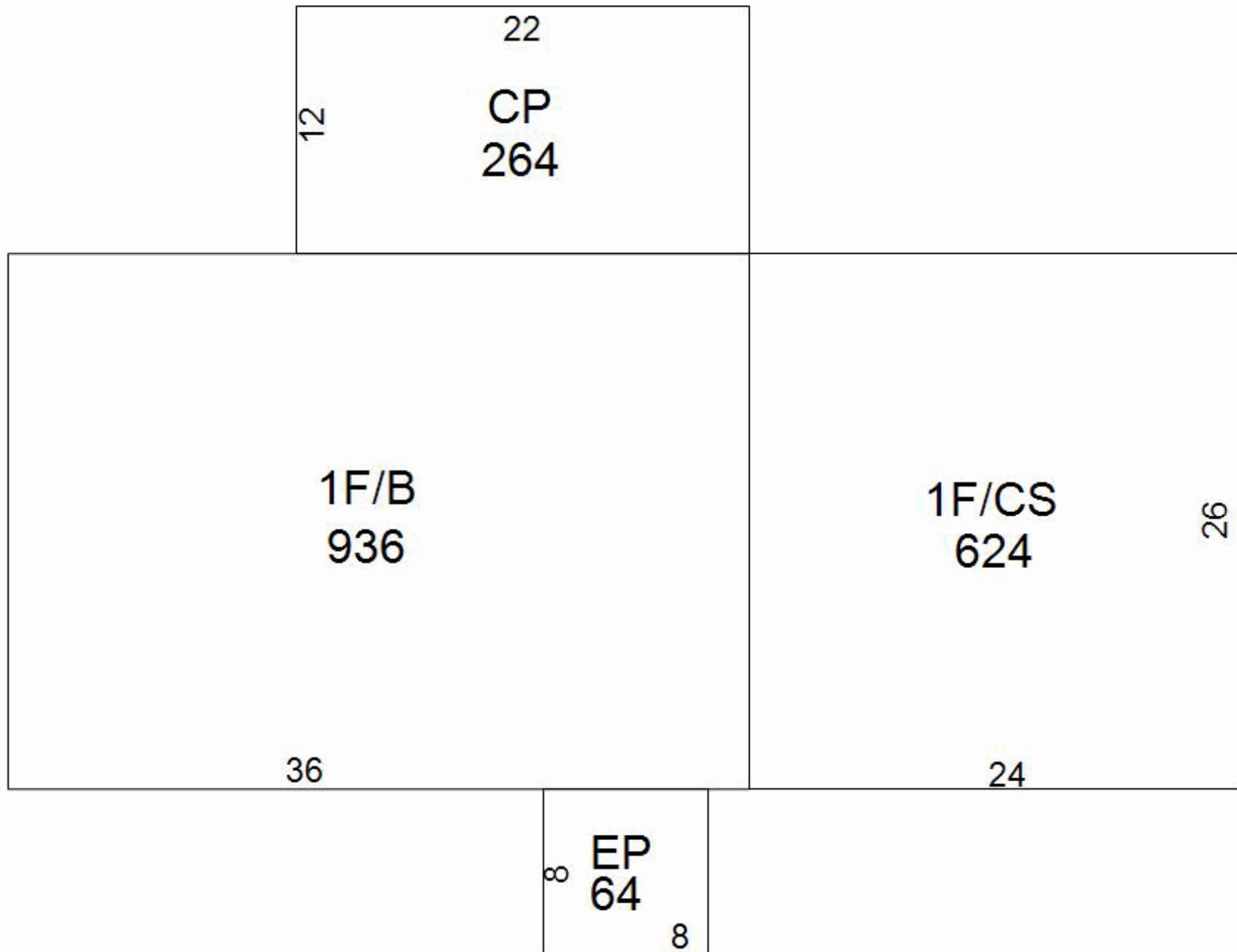

Total living area is 1,560 SF; building assessed value is \$213,500



Other Building Improvement (OBI)				
Main Structure		Modifications (Type, Size)		Photograph
OBI type: Pond Const type: Standard Pond Year built: 2010	Units: 1	Grade: C Condition: Average % complete: 100% Assessed \$: \$4,000		

Other Building Improvement (OBI)				
Main Structure		Modifications (Type, Size)		Photograph
# of identical OBIs: 1				
OBI type: Lean-to Const type: Pole frame, metal siding Year built: 1999	Width: 20 LF Depth: 54 LF Floor area: 1,080 SF Height: 10 LF	Grade: C Condition: Average % complete: 100% Assessed \$: \$2,600		

Other Building Improvement (OBI)				
Main Structure		Modifications (Type, Size)		Photograph
# of identical OBIs: 1				
OBI type: Farm implement building, pole Const type: Pole frame, metal siding Year built: 1999	Width: 58 LF Depth: 54 LF Floor area: 3,132 SF Height: 12 LF	Grade: C Condition: Fair % complete: 100% Assessed \$: \$19,800		

Other Building Improvement (OBI)				
Main Structure		Modifications (Type, Size)		Photograph
# of identical OBIs: 1				
OBI type: Garage Const type: Detached, pole frame Year built: 1999	Width: 36 LF Depth: 30 LF Floor area: 1,080 SF Height: 0 LF	Grade: C Condition: Average % complete: 100% Assessed \$: \$12,200		

Other Building Improvement (OBI)				
Main Structure		Modifications (Type, Size)		Photograph
# of identical OBIs: 1				
OBI type: Garage Const type: Detached, frame or cb Year built: 2000	Width: 24 LF Depth: 30 LF Floor area: 720 SF Height: 0 LF	Grade: C Condition: Average % complete: 100% Assessed \$: \$12,900		

2023 Property Records for Town of Lima, Sheboygan County

February 8, 2024

Other Building Improvement (OBI)					
Main Structure				Modifications (Type, Size)	Photograph
OBI type: Septic	Units: 1	Grade: C			not available
Const type: Conventional		Condition: Average			
Year built:		% complete: 100%			
		Assessed \$: \$2,500			

Other Building Improvement (OBI)					
Main Structure				Modifications (Type, Size)	Photograph
OBI type: Well	Units: 1	Grade: C			not available
Const type: Drilled		Condition: Average			
Year built:		% complete: 100%			
		Assessed \$: \$2,500			

Building Permits				
Issued	Permit #	Purpose	\$ Amount	Completed
9/28/2018	18202	Re-roof, siding	\$14,840	1/1/2019

Sales History		
Date	Price	Type