

2023 Property Records for Town of Lima, Sheboygan County

March 7, 2024

Tax key number: 59008091311

Property address: N4562 County Rd I

Traffic / water / sanitary: Medium / Well water / Septic

Legal description: LOT 1 CSM V 6 P 140 & A-9757 PRT SW SE, SEC 2, COM 1327.15' N & S88 DEG 47'E 87.66' FROM S1/4 COR, SD SEC, TH S88 DEG 47'E 745.30', S46 DEG 15'40"W 476.73', S43 DEG 26'W 146.85' N36 DEG 14'W 561.28', TH S88 DEG 47'E 32' TO BEG.

Summary of Assessment	
Land	\$60,200
Improvements	\$243,100
Total value	\$303,300

Land									
Qty	Land Use	Width	Depth	Square Feet	Acres	Water Frontage	Tax Class	Special Tax Program	Assess Value
1	Residential			171,191	3.930	Pond (Prime)	Residential		\$60,200

Residential Building			
Year built:	1900	Full basement:	1,040 SF
Year remodeled:	1996	Crawl space:	
Stories:	2 story	Rec room (rating):	
Style:	Duplex	Fin bsmt living area:	
Use:	2 Family	First floor:	1,040 SF
Exterior wall:	Brick	Second floor:	832 SF
Masonry adjust:	336 SF	Third floor:	
Roof type:	Asphalt shingles	Half story:	0 SF
Heating:	Gas, forced air	Finished attic:	
Cooling:	A/C, same ducts	Unfinished attic:	
Bedrooms:	3	Unfinished area:	
Family rooms:		Deck	100 SF
Baths:	2 full, 0 half	Deck	252 SF
Other rooms:		Deck	252 SF
Whirl / hot tubs:		Enclosed porch	144 SF
Add'l plumb fixt:	1		
Masonry FPs:			
Metal FPs:			
Gas only FPs:			
Bsmt garage:		Grade:	C+
Shed dormers:		Condition:	Average
Gable/hip dorm:		Percent complete:	100%



Total living area is 1,872 SF; building assessed value is \$186,100

2023 Property Records for Town of Lima, Sheboygan County

March 7, 2024

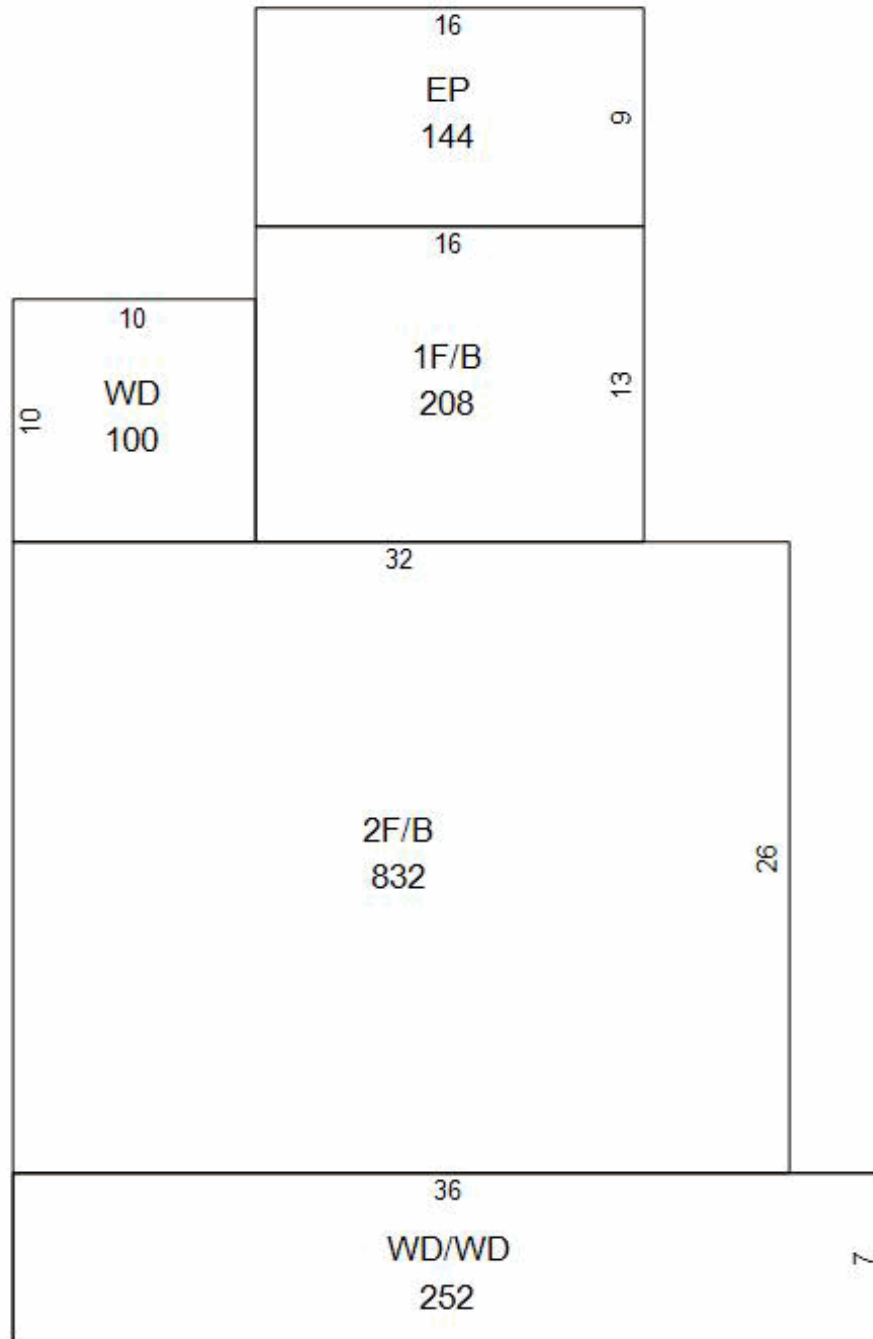

2023 Property Records for Town of Lima, Sheboygan County

March 7, 2024

Other Building Improvement (OBI)				
Main Structure		Modifications (Type, Size)		Photograph
OBI type: Pond Const type: Standard Pond Year built:	Units: 1	Grade: C Condition: Average % complete: 100% Assessed \$: \$4,000		

Other Building Improvement (OBI)				
Main Structure		Modifications (Type, Size)		Photograph
# of identical OBIs: 1				
OBI type: Garage Const type: Detached, pole frame Year built: 1984	Width: 42 LF Depth: 60 LF Floor area: 2,520 SF Height: 0 LF	Grade: C Condition: Average % complete: 100% Assessed \$: \$23,500		

Other Building Improvement (OBI)				
Main Structure		Modifications (Type, Size)		Photograph
OBI type: Well Const type: Drilled Year built:	Units: 1	Grade: C Condition: Average % complete: 100% Assessed \$: \$2,500		not available

Other Building Improvement (OBI)				
Main Structure		Modifications (Type, Size)		Photograph
OBI type: Septic Const type: Conventional Year built:	Units: 1	Grade: C Condition: Average % complete: 100% Assessed \$: \$2,500		not available

Other Building Improvement (OBI)				
Main Structure		Modifications (Type, Size)		Photograph
# of identical OBIs: 1				
OBI type: Garage Const type: Detached, frame or cb Year built: 1984	Width: 24 LF Depth: 78 LF Floor area: 1,872 SF Height: 0 LF	Grade: C Condition: Average % complete: 100% Assessed \$: \$24,500		

Building Permits				
Issued	Permit #	Purpose	\$ Amount	Completed

Sales History		
Date	Price	Type
7/31/2020	\$317,500	Valid improved sale