

2024 Property Records for Town of Schleswig, Manitowoc County

March 11, 2024

Tax key number: 016-001-004-002.00

Property address: 10402 Hwy A

Traffic / water / sanitary: Medium / Well water / Septic/Mound

Summary of Assessment	
Land	\$31,200
Improvements	\$94,700
Total value	\$125,900

Land									
Qty	Land Use	Width	Depth	Square Feet	Acres	Water Frontage	Tax Class	Special Tax Program	Assess Value
1	Residential			110,207	2.530	None	Residential		\$31,200

Residential Building			
Year built:	1900	Full basement:	974 SF
Stories:	1 story w/attic	Crawl space:	
Style:	Residence - Old Style	Rec room (rating):	
Use:	Single family	Fin bsmt living area:	
Exterior wall:	Alum/vinyl	First floor:	1,415 SF
Masonry adjust:		Second floor:	
Roof type:	Asphalt shingles	Finished attic:	375 SF
Heat type:	Basic	Unfinished attic:	
Fuel type:	Gas	Unfinished area:	
System type:	Warm air	Attachments:	None
Bedrooms:	3		
Family rooms:	1		
Full baths:	1		
Half baths:			
Other rooms:	3		
FP stacks:			
FP openings:		Grade:	D+
Metal FPs:		Condition:	Average
Bsmnt garage:		% complete:	100%



Total living area is 1,790 SF; building assessed value is \$72,500

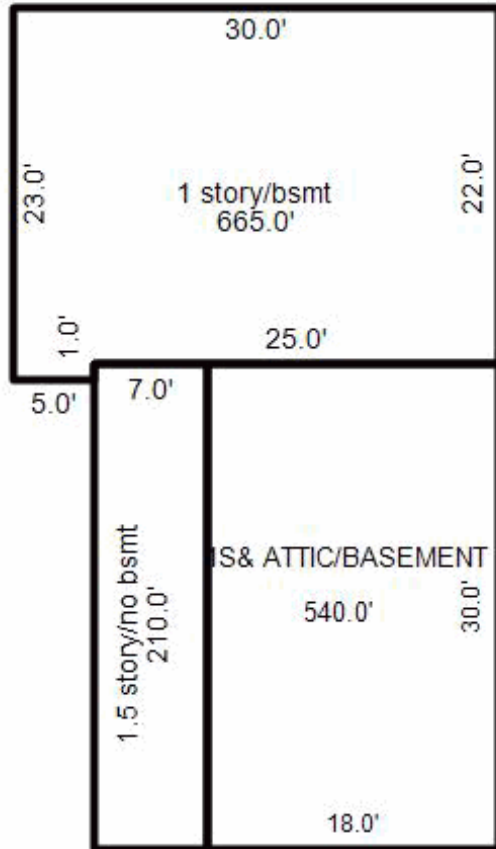

2024 Property Records for Town of Schleswig, Manitowoc County

March 11, 2024

# of identical OBIs: 1		Other Building Improvement (OBI)		
Main Structure		Modifications (Type, Size)		Photograph
OBI type: Utility Shed_RS1	Width: 10 LF	Grade: D		not available
Const type: std construction	Depth: 12 LF	Condition: Average		
Year built:	Floor area: 120 SF	% complete: 100%	Assessed \$: \$200	

# of identical OBIs: 1		Other Building Improvement (OBI)		
Main Structure		Modifications (Type, Size)		Photograph
OBI type: Well & Septic/Mound	Width: 1 LF	Grade: C		not available
Const type: std construction	Depth: 1 LF	Condition:		
Year built:	Floor area: 1 SF	% complete: 100%	Assessed \$: \$7,900	

# of identical OBIs: 1		Other Building Improvement (OBI)		
Main Structure		Modifications (Type, Size)		Photograph
OBI type: Barn/Heifers/Horses/Idle_AB1,A	Width: 40 LF	Grade: F		
Const type: std construction	Depth: 64 LF	Condition:		
Year built:	Floor area: 2,560 SF	% complete: 100%	Assessed \$: \$0	

# of identical OBIs: 1		Other Building Improvement (OBI)		
Main Structure		Modifications (Type, Size)		Photograph
OBI type: Pole Shed (cement) - AP1	Width: 44 LF	Grade: D		not available
Const type: std construction	Depth: 64 LF	Condition:		
Year built:	Floor area: 2,816 SF	% complete: 100%	Assessed \$: \$14,100	