

# 2019 Property Records for Town of Lyndon, Sheboygan County

March 8, 2021

**Tax key number:** 59010128541

**Property address:** W6635 County Rd F

Traffic / water / sanitary: Medium / Well water / Septic

Legal description: TR 1 CSM V3 P 91 & PARCEL B A-8508 - PRT NW SE, SEC 30, COM 685.67'E OF NW COR SE1/4 SD SEC, TH S 796.34', N53 DEG 38'E 368.61', N45 DEG 56'E 62.55', N0 DEG 7'E 534.27', TH W 342.85' TO BEG.

Summary of Assessment	
Land	\$47,300
Improvements	\$187,200
Total value	\$234,500

Land									
Qty	Land Use	Width	Depth	Square Feet	Acres	Water Frontage	Tax Class	Special Tax Program	Assess Value
1	Residential			229,126	5.260	None	Residential		\$47,300

Residential Building									
Year built:	1978	Full basement:	1,302 SF						
Year remodeled:		Crawl space:							
Stories:	1 story	Rec room (rating):							
Style:	Split level	Fin bsmt living area:	696 SF						
Use:	Single family	First floor:	1,266 SF						
Exterior wall:	Wood	Second floor:							
Masonry adjust:		Third floor:							
Roof type:	Asphalt shingles	Finished attic:							
Heating:	Gas, forced air	Unfinished attic:							
Cooling:	A/C, same ducts	Unfinished area:							
Bedrooms:	3	Deck	322 SF						
Family rooms:		Garage	672 SF						
Baths:	2 full, 0 half								
Other rooms:	3								
Whirl / hot tubs:	1 whirlpool, 1 hot								
Add'l plumb fixt:	1								
Masonry FPs:	1 stacks, 1 openings								
Metal FPs:									
Gas only FPs:		Grade:	C						
Bsmt garage:		Condition:	Average						
Shed dormers:		Energy adjustment:	No						
Gable/hip dorm:		Percent complete:	100%						

Total living area is 1,962 SF; building assessed value is \$137,100

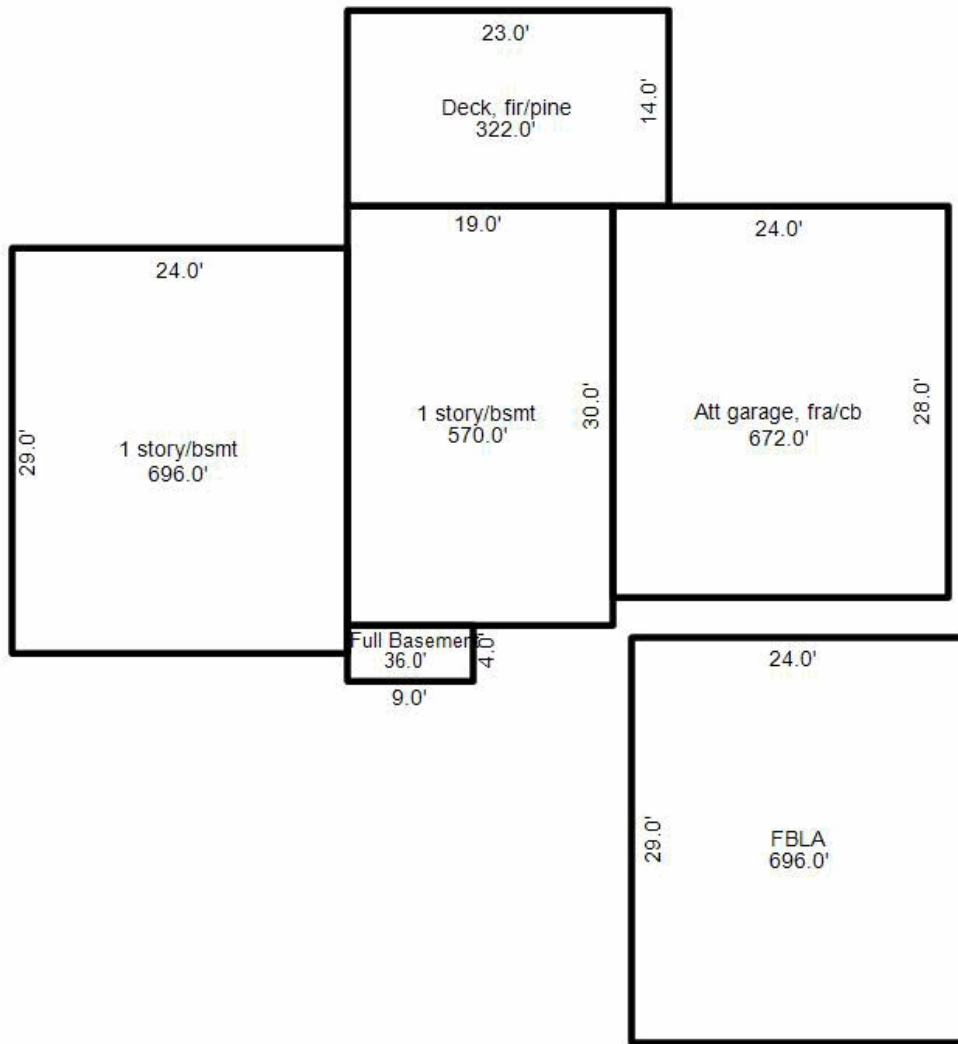

# of identical OBIs: 1		Other Building Improvement (OBI)			
Main Structure			Modifications (Type, Size)		Photograph
OBI type:	Garage	Width: 40 LF	Grade: B		
Const type:	Detached, frame or cb	Depth: 40 LF	Condition: Good		
Year built:	2014	Floor area: 1,600 SF	% complete: 100%		
		Assessed \$: \$48,400			

Other Improvements		
Tax Class	Description	Assess Value
Residential	Asph Drive	\$1,500
Residential	SV Sheds	\$200

Building Permits				
Issued	Permit #	Purpose	\$ Amount	Completed
8/25/2014	2306	New Detached Garage w/Attic	\$30,000	12/31/2014

Sales History		
Date	Price	Type
7/2/2002	\$93,500	Other (see comment)
2/21/2001	\$155,900	Valid improved sale