



Property Information



Parcel Number: 031-540-002-003.00	Physical Address: 1410 WEBSTER LN , 53015	Municipality: Cleveland, Village of	
Owner Name: GEORGE P DENARDIS 1410 WEBSTER LN CLEVELAND, WI 53015	Legal Description: 668-103 EVERGREEN HEIGHTS LOT 3 BLK. 2 NW1/4 SW1/4 S.28 T.17 R.23	Land Use: Residential	Date of Inspection: 5/24/2010

Neighborhood: 01 Neighborhood Name - Cleveland

Property Photograph:



Property Sketch:

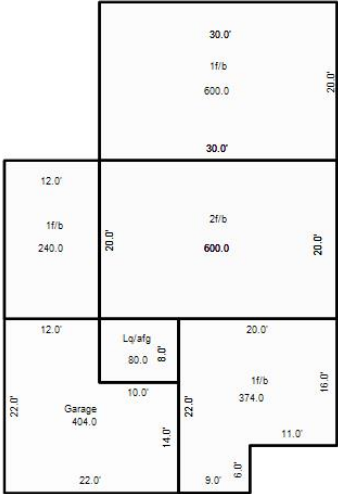

Building Description: 031-540-002-003.00- 1

Year Built: 1/2/1978 Building Type/Style: 15-Modern Multi Story Story Height: 2.0 Grade: C+ CDU/Overall Condition: Good Interior Condition: Same Kitchen Condition: Good Bath Condition: Good	Exterior Wall: 04-Alum/Vinyl Bedrooms: 5 Full Baths: 2 Half Baths: 1 Room Count: 9 Basement Description: Full Basement Heating: Air Conditioning - Same Ducts Type of Fuel: Gas Type of System: Hot Water
--	--

Square Footage / Attachments:

Finished Basement Living Area: 0 First Story: 1,814 Basement Feature Rec. Room Area:	Total Living Area: 2,494
Attachment Description(s): 13-AFG	Area: 484
Feature Description(s): 05-Metal Fireplace	Area: 1

Detached Improvement: 031-540-002-003.00-1

Detached Improvement Type: RS1-Frame Utility Shed Year Built: 1/2/1978 Height:	Detached Improvement Class: A-Residential Detached Improvement Condition: Good Square Feet: 96
---	---

Permit / Construction History:

<u>Date of Permit:</u>	<u>Permit Number:</u>	<u>Permit Amount:</u>	<u>Details of Permit:</u>
4/4/2024	24-5187	\$0	replace circuit breaker box & run cable to garage for EV charger
8/26/2009	635402	\$1	new dwelling to start
8/24/2009	636133	\$150,000	to home - window ,and siding
4/24/2017	713260	\$4,000	
7/7/2008	604325	\$24,000	h2o htr- 4 x 200 well for fur
9/30/2018	18-4541	\$5,900	re-roof
4/24/2017	17-4346	\$4,000	chimney masonry repair

Ownership / Sales History:

<u>Date of Sale:</u>	<u>Sale Document:</u>	<u>Purchase Amount:</u>	<u>Sale Validity:</u>	<u>Conveyance Type:</u>	<u>Sale Type:</u>
----------------------	-----------------------	-------------------------	-----------------------	-------------------------	-------------------

Land Data - Land Item: 1

Land Class: A-Residential

Pricing / Unit of Measure: Square Footage

Square Footage: 16,988

Depth: 0

Land Value: \$22,200

Land Sub-Class: A-Residential Primary Site

Acreage: 0.390

Frontage:

Width:

Total Improvement Value:	\$224,700
Total Land Value:	\$22,200
Total Assessed Value:	\$246,900