

2024 Property Records for Town of Fredonia, Ozaukee Country

February 24, 2025

Tax key number: 04-021-16-006.00

Property address: N5715 County Rd I

Traffic / water / sanitary: Medium / Well water / Septic

Summary of Assessment	
Land	\$51,300
Improvements	\$129,700
Total value	\$181,000

Land									
Qty	Land Use	Width	Depth	Square Feet	Acres	Water Frontage	Tax Class	Special Tax Program	Assess Value
1	Residential			50,573	1.161	None	Residential		\$51,300

Residential Building									
Year built:	1870	Full basement:	323 SF						
Year remodeled:	1986	Crawl space:	466 SF						
Stories:	1.5 story	Rec room (rating):							
Style:	Old style	Fin bsmt living area:							
Use:	Single family	First floor:	789 SF						
Exterior wall:	Alum/vinyl	Second floor:	261 SF						
Masonry adjust:		Third floor:							
Roof type:	Asphalt shingles	Finished attic:							
Heating:	Electric, baseboard	Unfinished attic:							
Cooling:	No A/C	Unfinished area:							
Bedrooms:	2	Attachments:	None						
Family rooms:									
Baths:	1 full, 0 half								
Other rooms:	3								
Whirl / hot tubs:									
Add'l plumb fixt:									
Masonry FPs:									
Metal FPs:	1 stacks, 1 openings								
Gas only FPs:		Grade:	D+						
Bsmt garage:		Condition:	Average						
Shed dormers:		Energy adjustment:	No						
Gable/hip dorm:		Percent complete:	100%						

Total living area is 1,050 SF; building assessed value is \$115,500

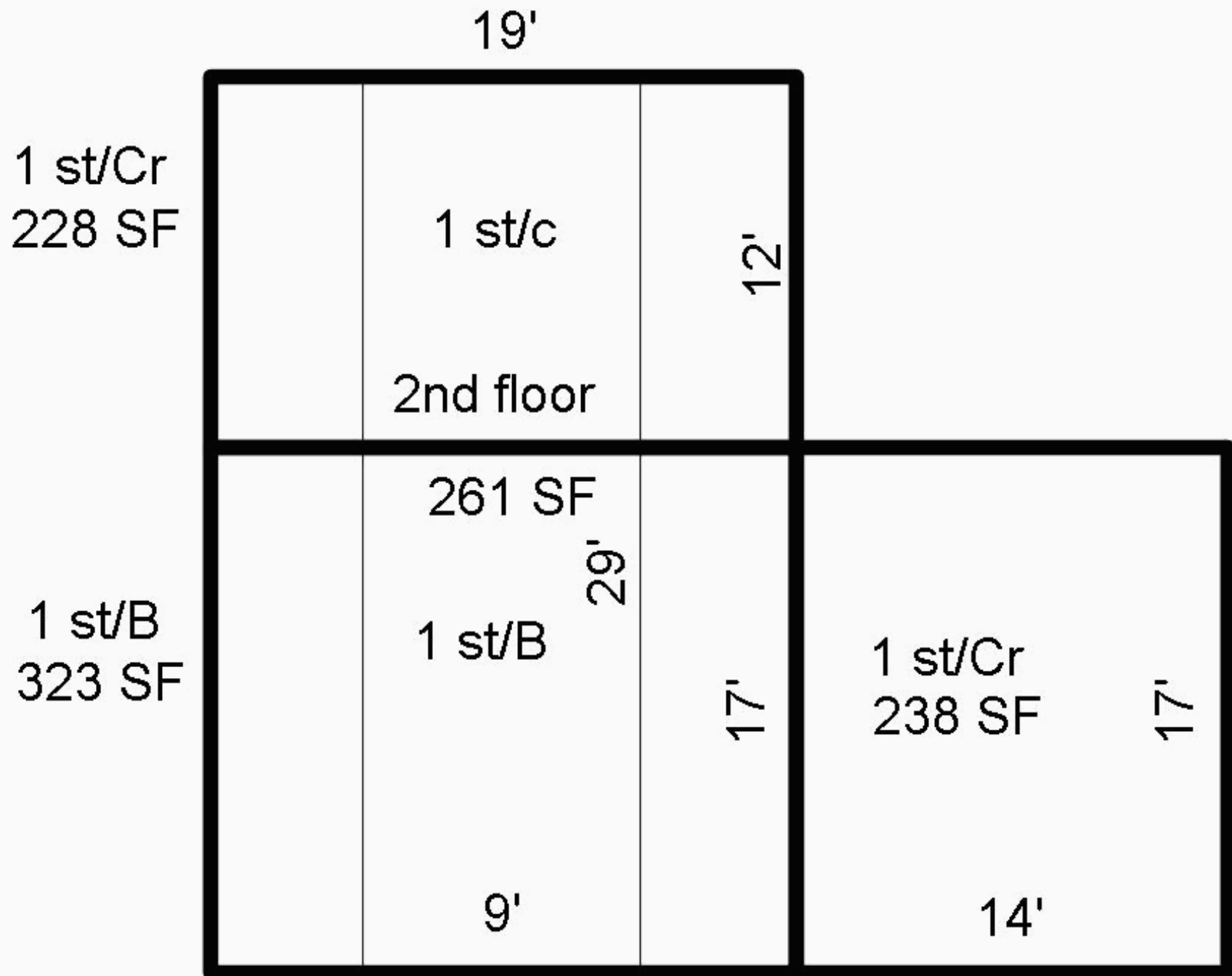

2024 Property Records for Town of Fredonia, Ozaukee Country

February 24, 2025

# of identical OBIs: 1		Other Building Improvement (OBI)		
Main Structure		Modifications (Type, Size)		Photograph
OBI type: Garage	Width: 24 LF	Grade: C		not available
Const type: Detached, frame or cb	Depth: 20 LF	Condition: Average		
Year built:	Floor area: 480 SF	% complete: 100%		
		Assessed \$: \$13,600		

# of identical OBIs: 1		Other Building Improvement (OBI)		
Main Structure		Modifications (Type, Size)		Photograph
OBI type: Utility shed, residential	Width: 14 LF	Grade: C		not available
Const type: Frame	Depth: 14 LF	Condition: Average		
Year built:	Floor area: 196 SF	% complete: 100%		
		Assessed \$: \$600		

Building Permits				
Issued	Permit #	Purpose	\$ Amount	Completed

Sales History		
Date	Price	Type
5/20/2020	\$130,200	Not a market sale