

2024 Property Records for Town of Meeme, Manitowoc Country

June 30, 2025

Tax key number: 012-008-002-001.05

Property address: 11215 Spring Lake Rd

Traffic / water / sanitary: Light / Well water / Septic

Summary of Assessment	
Land	\$15,900
Improvements	\$171,700
Total value	\$187,600

Land									
Qty	Land Use	Width	Depth	Square Feet	Acres	Water Frontage	Tax Class	Special Tax Program	Assess Value
1	Residential			43,560	1.000	None	Residential		\$15,000
1	Residential			204,732	4.700	None	1st grade tillable		\$900

Residential Building			
Year built:	1988	Full basement:	1,059 SF
Year remodeled:		Crawl space:	
Stories:	1.5 story	Rec room (rating):	396 SF (AV)
Style:	Contemporary	Fin bsmt living area:	
Use:	Single family	First floor:	1,059 SF
Exterior wall:	Alum/vinyl	Second floor:	518 SF
Masonry adjust:		Third floor:	
Roof type:	Asphalt shingles	Finished attic:	
Heating:	Gas, forced air	Unfinished attic:	
Cooling:	No A/C	Unfinished area:	
Bedrooms:	3	Garage	688 SF
Family rooms:		Deck	304 SF
Baths:	2 full, 0 half		
Other rooms:	3		
Whirl / hot tubs:			
Add'l plumb fixt:			
Masonry FPs:			
Metal FPs:			
Gas only FPs:		Grade:	C+
Bsmt garage:		Condition:	Average
Shed dormers:		Energy adjustment:	No
Gable/hip dorm:		Percent complete:	100%



Total living area is 1,577 SF; building assessed value is \$153,500

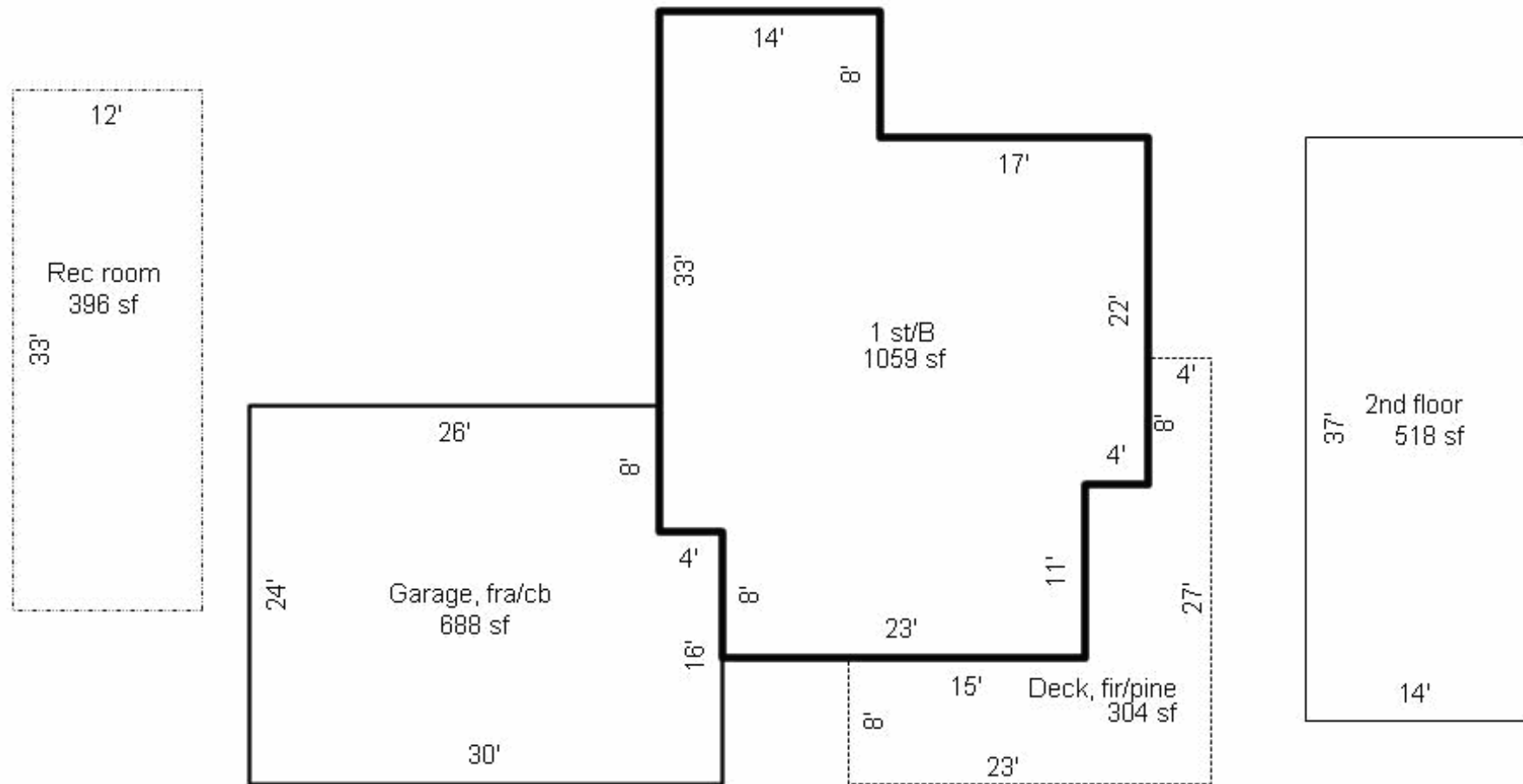

2024 Property Records for Town of Meeme, Manitowoc Country

June 30, 2025

# of identical OBIs: 1		Other Building Improvement (OBI)		
Main Structure		Modifications (Type, Size)		Photograph
OBI type: Garage	Width: 28 LF	Grade: C		not available
Const type: Detached, frame or cb	Depth: 36 LF	Condition: Average		
Year built: 2006	Floor area: 1,008 SF	% complete: 100%		
		Assessed \$: \$18,200		