

2025 Assessment Year

Town of Plymouth, Sheboygan County (2025 Assessment Year)

Property Records



Current Owner		Districts		General Information			
TRAVIS J TREPANIER		Sheboygan County	Sheboygan County	Parcel Number:	59016245059		
		Plymouth	Town of Plymouth	Alternate ID:	59016245059		
		School	School 4473	Neighborhood:	103- Good Subdivision		
		Voc/ Tech College	Vtech School 1100	Neighborhood Group:	Residential		
				SANITARY	Septic		
				TRAFFIC	Cul de sac		
				WATER	Well water		

		*Legal Description			Inspection Data		
Total Acreage:	3.06	LA FERME GENTINE LOT 31			Date	User	Type
Total Sq. Ft:	133,294						
Actual Frontage:							
Effective Frontage:	0						
Effective Depth:	0						
Water Influence:	None	*This legal description may be abbreviated and is for assessment purposes only.					
Water Desirability:	None						
		Section:	09	Township:	15	Range:	21E
		Subdivision:		Block:		Lot / Unit:	

Property Sales / Ownership History						
Sale Date	Sale Price	Sale Typ	Validity	Document #	Deed Type	Grantor
7/15/2005	\$304,000	IMPROVED	2 - Valid improved sale		1 - Warranty	Trepanier Travis J

Summary of 2025 Assessment Year Values					
Tax Classification	Code	Acres	Land	Improvement	Total
Residential	1	3.060	\$68,800	\$411,600	\$480,400
Total Real Estate - All Columns:		3.060	\$68,800	\$411,600	\$480,400

Assessment Value History					
Year	Code	Acres	Land	Improvement	Total
2024	1	3.060	\$68,800	\$411,600	\$480,400
	Totals	3.060	\$68,800	\$411,600	\$480,400
2023	1	3.060	\$68,800	\$411,600	\$480,400
	Totals	3.060	\$68,800	\$411,600	\$480,400
2022	1	3.060	\$68,800	\$411,600	\$480,400
	Totals	3.060	\$68,800	\$411,600	\$480,400

Special Tax Programs (MFL/PFC) and Exempt					
Tax Classification	Code	Acres	Land	Improvement	Total

Permit Information				
Issued Date	Number	Amount	Status	Purpose/Description

2025 Assessment Year

Town of Plymouth, Sheboygan County (2025 Assessment Year)

Property Records

Land Information										
Land Line	Tax Classification	MAR Subclass	Acres	Sq. Ft.	Width	Depth	Unit of Measure	Units	Unit Rate	Land Value
1	Residential		3.060	133,294	0	0	ACREAGE	3.060	22477.12	\$68,800
Total All Columns:			3.060	133,294					Total All Columns:	\$68,800

Other Building Improvements (OBI)											
Bldg #	Tax Class	Style	Class/Const	Year Built	Grade	Condition	Width	Length	Height	Units	OBI Value
2	Residential	Garage	Detached, frame or cb	1980	C	Average	26	36	9	936	\$13,600
Total Columns:											\$13,600

Extra Features (XF)												
XF #	Tax Class	Code	Alt. Description	Assoc. Bldg	Year Built	Grade	Condition	Width	Length	Height	Units	XF Value
1	Residential	Well, drilled			1978	C	Average	0	0	0	1	\$3,000
2	Residential	Septic, conventional			1978	C	Average	0	0	0	1	\$3,000
Total Columns:												\$6,000

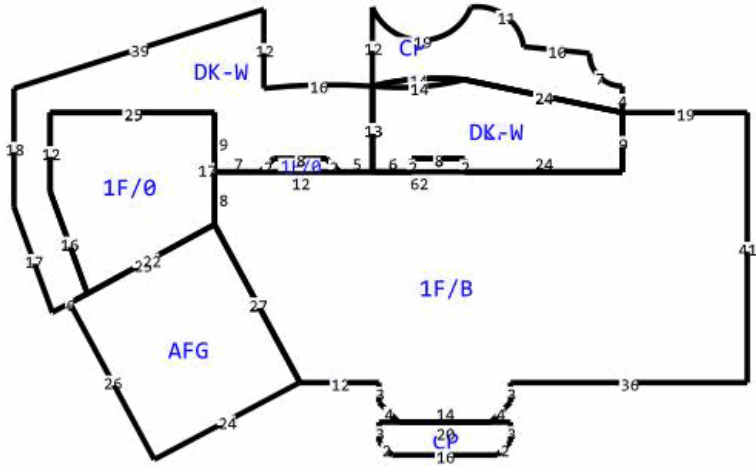

Building Data			
Tax Classification	Residential	Additional Fixtures	NO
Building Number/Section	1 - 1	Hot Tub	NO
Building Style	Ranch	Plumbing Rough In	NO
Quality/Grade	C+	Family Rooms	NO
Year Built	1978	Other Rooms	NO
Effective Year Built	1978	Masonry Fireplace Stacks	YES
Class/Const	FRAME	Masonry Fireplace Openings	YES
Overall Condition (CDU)	Average	Masonry Additional Stories	NO
Occupancy (Use)	Single Family	Metal Fireplace Stacks	NO
Living/Apartment Units	1	Metal Fireplace Openings	NO
Stories	1 story	Metal Additional Stories	NO
Roof Type	Asphalt shingles	Gas Fireplace Openings	NO
Basement Type	Not Specified	Equipment Rating	Average
Exterior Wall	Wood	Kitchen Rating	Average
Masonry Adjustment SF	665	Bath Rating	Average
Shed Dormer LF	0	Interior Rating	Average
Gable Dormer LF	0	Exterior Rating	Average
Heating	Gas, forced air	Rec Room Rating	No Code
Air Conditioning	A/C (same ducts)		
Bedrooms	4		
Bath-Full	3		
Bath-Half	1		
Whirlpool	1		

Building Area					
Living Area	Sq. Ft.	Other Area	Sq. Ft.	Attachment Area	Sq. Ft.
First Floor Area	3,280	Unfinished Attic Area	0	Attached garage, frame	681
Second Floor Area	0	Unfinished Area	0	Concrete patio	858
Third Floor Area	0	Basement Area	2,718	Deck, wood	1,258
Half Floor Area	0	Crawlspace Area	0		
Finished Attic Area	0	Finished Basement Area (FBLA)	2,400		
		Rec Room Area	0		
Total Above Grade Living Area		Total Sq. Ft. Living Area (SFLA)			