

2025 Property Records for Village of Waldo, Sheboygan County

August 4, 2025

Tax key number: 59191771546

Property address: 348 W 1st St

Traffic / water / sanitary: Heavy / City water / Sewer

Legal description: A-28388 - PRT SW SE, SEC 14, COM N89 DEG 41'38"W 1295.47' FROM SE COR, SD SEC, TH N00 DEG 20'39"E 294.71', N89 DEG 41'38"W 206.84', S00 DEG 09'38"E 294.71', TH S89 DEG 41'38"E 205.79' TO BEG.

Summary of Assessment	
Land	\$53,500
Improvements	\$82,900
Total value	\$136,400

Land									
Qty	Land Use	Width	Depth	Square Feet	Acres	Water Frontage	Tax Class	Special Tax Program	Assess Value
1	Commercial			60,984	1.400	None	Commercial		\$53,500

Commercial Building (Former School)

Assessed value: \$82,600

Section name: Section 1
 Year built: 1904
 % complete: 100%
 Stories: 2.00
 Perimeter: 238 LF
 Total area: 6,726 SF (all stories)



Occupancies	Designed Use	Actual Use	Units	Area per Unit	Construction Class	Avg Ht	Quality	CDU
	Elementary school (entire)		1	6,726	Masonry bearing walls	12.00	D (FR)	Average

Exterior walls HVAC Fire alarms	Component Description		Count	Stops	Area (sf)	Area (%)	Quality
	Brick, Solid				6,726	100.0%	D (FR)
	Steam				6,726	100.0%	F (VP)
	Fire alarm system				6,726	100.0%	D (FR)

Section 1 basement
 Levels: 1.00
 Perimeter: 238 LF
 Total area: 3,363 SF (all levels in basement)

Occupancies	Designed Use	Actual Use	Units	Area per Unit	Basement Type	Construction Class	Avg Ht	Quality	CDU
	Elementary school (entire)		1	3,363	Unfinished	Masonry bearing walls	10.00	D (FR)	Average

HVAC	Component Description		Count	Stops	Area (sf)	Area (%)	Quality
	No HVAC				3,363	100.0%	C (AV)

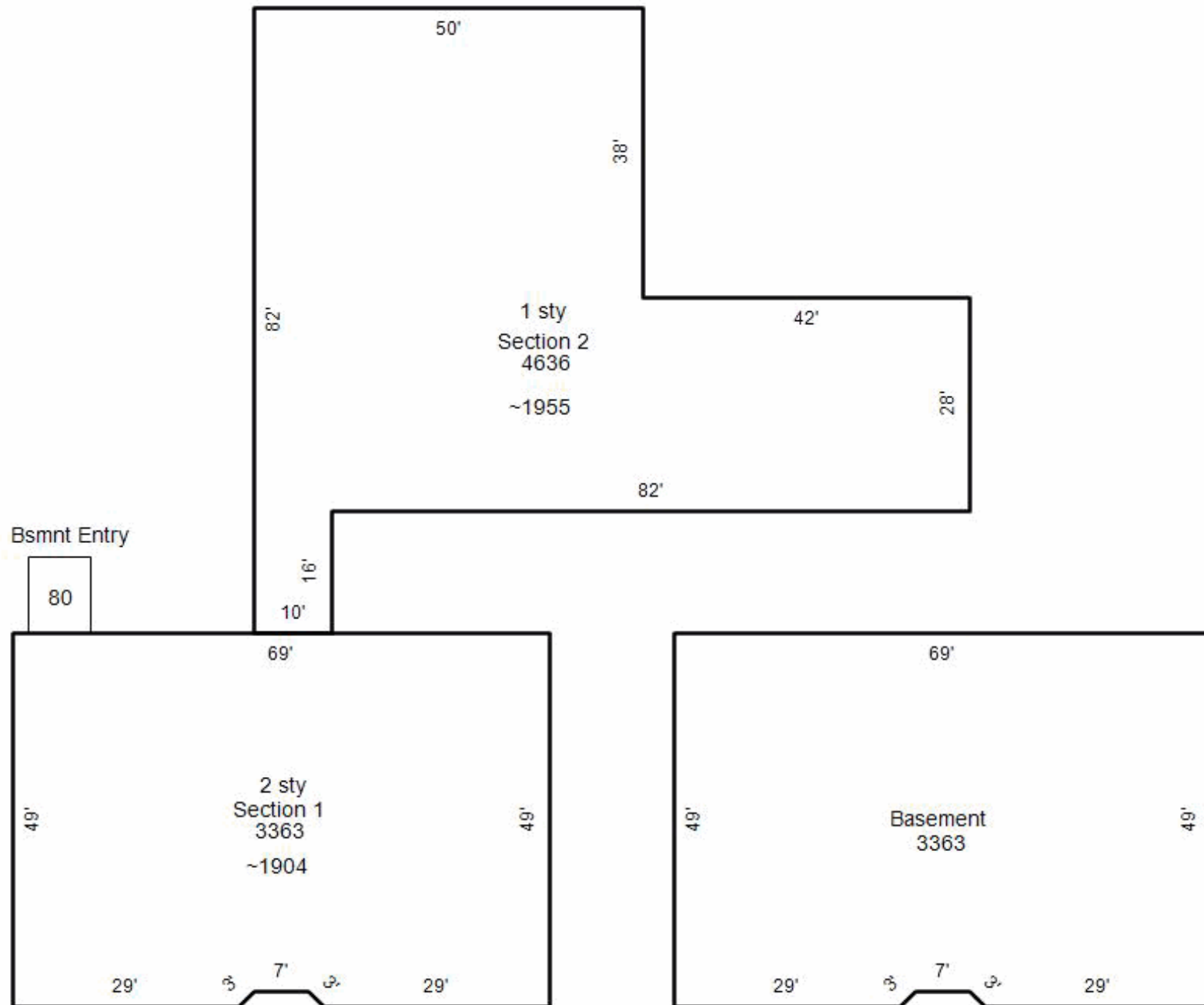

2025 Property Records for Village of Waldo, Sheboygan County

August 4, 2025

Section name: Section 2
 Year built: 1955
 % complete: 100%
 Stories: 1.00
 Perimeter: 348 LF
 Total area: 4,636 SF (all stories)

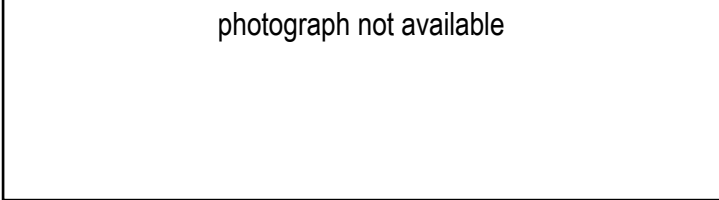

	Designed Use	Actual Use	Units	Area per Unit	Construction Class	Avg Ht	Quality	CDU
Occupancies	Commons (schools)		1	4,636	Metal frame and walls	10.00	D (FR)	Average

	Component Description	Count	Stops	Area (sf)	Area (%)	Quality
Exterior walls	PE-Metal Sandwich Panels			4,636	100.0%	D (FR)
HVAC	Forced air unit			1,854	40.0%	D (FR)
	No HVAC			2,782	60.0%	C (AV)
Fire alarms	Fire alarm system			4,636	100.0%	D (FR)



2025 Property Records for Village of Waldo, Sheboygan County

August 4, 2025

# of identical OBIs: 1		Other Building Improvement (OBI)		
Main Structure		Modifications (Type, Size)		Photograph
OBI type: Utility shed	Width: 10 LF	Grade: C		not available
Const type: std construction	Depth: 12 LF	Condition: Average		
Year built:	Floor area: 120 SF	% complete: 100%		
		Assessed \$: \$300		

Building Permits				
Issued	Permit #	Purpose	\$ Amount	Completed
7/13/2010	10007	Room dividers/ new roof	\$0	1/25/2011

Sales History		
Date	Price	Type
1/27/2021	\$120,000	Valid improved sale
3/1/2016	\$29,600	Not a market sale
12/18/2009	\$76,250	Valid improved sale
6/28/2001	\$100,000	Not a market sale