

2025 Assessment Year

Town of Sheboygan, Sheboygan County (2025 Assessment Year)

Property Records



Current Owner
GERALD E VOELKER

Districts	
Sheboygan County	Sheboygan County
Sheboygan	Town of Sheboygan
Sanitary	Sanitary District #2 (Sewer)
School	Sch D of Sheboygan (5271)
Voc/Tech College	Vtech School 1100
Water Drainage	Sanitary District #3 (Water)

General Information			
Parcel Number:	358480		
Alternate ID:	59024358480		
Neighborhood:	128 - Parke-Ridge		
Neighborhood Group:	Residential		
Sanitary	Sewer		
Traffic	Light		
Water	Well water		

Total Acreage:	0.51
Total Sq. Ft:	22,216
Actual Frontage:	
Effective Frontage:	0
Effective Depth:	0
Water Influence:	None
Water Desirability:	None

*Legal Description		
PARKE-RIDGE SUBD. THE S1/2 OF LOT 4 BLK 2.		
*This legal description may be abbreviated and is for assessment purposes only.		
Section:	05	Township: 15
Subdivision:		Range: 23E
		Block:
		Lot / Unit:

Inspection Data		
Date	User	Type

Property Sales / Ownership History						
Sale Date	Sale Price	Sale Typ	Validity	Document #	Deed Type	Grantor
8/15/2003	\$157,900	IMPROVED	2 - Valid improved sale		1 - Warranty	Voelker Gerald E

Summary of 2025 Assessment Year Values					
Tax Classification	Code	Acres	Land	Improvement	Total
Residential	1	0.510	\$41,100	\$213,800	\$254,900
Total Real Estate - All Columns:		0.510	\$41,100	\$213,800	\$254,900

Assessment Value History					
Year	Code	Acres	Land	Improvement	Total
2025	1	0.510	\$41,100	\$213,800	\$254,900
	Totals	0.510	\$41,100	\$213,800	\$254,900
2024	1	0.510	\$41,100	\$213,800	\$254,900
	Totals	0.510	\$41,100	\$213,800	\$254,900
2023	1	0.510	\$30,100	\$110,200	\$140,300
	Totals	0.510	\$30,100	\$110,200	\$140,300

Special Tax Programs (MFL/PFC) and Exempt					
Tax Classification	Code	Acres	Land	Improvement	Total

Permit Information				
Issued Date	Number	Amount	Status	Purpose/Description
2014-12-16	27037	\$ 8500	Completed	New roof
2013-05-13	25290	\$ 24000	Completed	Kitchen remodel
2013-05-13	25290	\$ 50	Completed	Relocate kitchen sink
2013-05-13	25290	\$ 200	Completed	Electric for kitchen remodel

2025 Assessment Year

Town of Sheboygan, Sheboygan County (2025 Assessment Year)

Property Records

Land Information										
Land Line	Tax Classification	MAR Subclass	Acres	Sq. Ft.	Width	Depth	Unit of Measure	Units	Unit Rate	Land Value
1	Residential		0.510	22,216	0	0	Square Feet	22,216.000	1.85	\$41,100
Total All Columns:			0.510	22,216						\$41,100

Other Building Improvements (OBI)											
Bldg #	Tax Class	Style	Class/Const	Year Built	Grade	Condition	Width	Length	Height	Units	OBI Value
2	Residential	Garage	Detached, frame or cb	1971	D	Average	22	22	0	484	6,500
Total Columns:											6,500

Extra Features (XF)												
XF #	Tax Class	Code	Alt. Description	Assoc. Bldg	Year Built	Grade	Condition	Width	Length	Height	Units	XF Value
1	Residential	Well, drilled			1970	C	Average	0	0	0	1	\$2,500
Total Columns:											\$2,500	

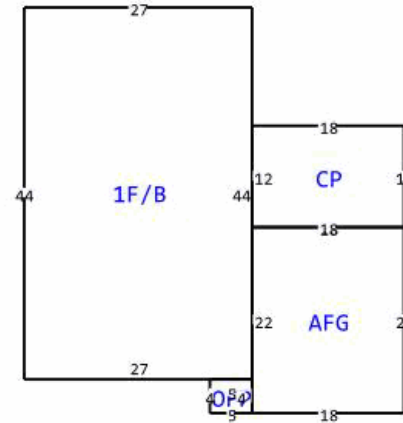

Building Data			
Tax Classification	Residential	Additional Fixtures	NO
Building Number/Section	1 - 1	Hot Tub	NO
Building Style	Ranch (1970+)	Plumbing Rough In	NO
Quality/Grade	C	Family Rooms	NO
Year Built	1970	Other Rooms	NO
Effective Year Built	1970	Masonry Fireplace Stacks	NO
Class/Const	Frame	Masonry Fireplace Openings	NO
Overall Condition (CDU)	Average	Masonry Additional Stories	NO
Occupancy (Use)	Single Family	Metal Fireplace Stacks	NO
Living/Apartment Units	1	Metal Fireplace Openings	NO
Stories	1 story	Metal Additional Stories	NO
Roof Type	Asphalt shingles	Gas Fireplace Openings	NO
Basement Type	Not Specified	Equipment Rating	Average
Exterior Wall	Alum/vinyl	Kitchen Rating	Excellent
Masonry Adjustment SF	60	Bath Rating	Average
Shed Dormer LF	0	Interior Rating	Average
Gable Dormer LF	0	Exterior Rating	Average
Heating	Gas, forced air	Rec Room Rating	Poor
Air Conditioning	A/C (same ducts)		
Bedrooms	3		
Bath-Full	1		
Bath-Half	1		
Whirlpool	0		

Building Area					
Living Area	Sq. Ft.	Other Area	Sq. Ft.	Attachment Area	Sq. Ft.
First Floor Area	1,188	Unfinished Attic Area	0	Attached garage, frame	396
Second Floor Area	0	Unfinished Area	0	Concrete patio	216
Third Floor Area	0	Basement Area	1,188	Open frame porch, first floor	20
Half Floor Area	0	Crawlspace Area	0		
Finished Attic Area	0	Finished Basement Area (FBLA)	0		
		Rec Room Area	713		
Total Above Grade Living Area	1,188	Total Sq. Ft. Living Area (SFLA)	1,188		