

2025 Property Records for Village of Elkhart Lake, Sheboygan Country

February 20, 2026

Tax key number: 59121584280

Property address: 464 E Rhine St

Traffic / water / sanitary: Light / City water / Sewer

| Summary of Assessment | |
|-----------------------|-----------|
| Land | \$45,000 |
| Improvements | \$171,500 |
| Total value | \$216,500 |

| Land | | | | | | | | | |
|------|-------------|-------|-------|-------------|-------|----------------|-------------|---------------------|--------------|
| Qty | Land Use | Width | Depth | Square Feet | Acres | Water Frontage | Tax Class | Special Tax Program | Assess Value |
| 1 | Residential | 60 | 405 | 24,300 | 0.558 | None | Residential | | \$45,000 |

| Residential Building | | | |
|----------------------|------------------|-----------------------|----------|
| Year built: | 1920 | Full basement: | 1,080 SF |
| Year remodeled: | | Crawl space: | |
| Stories: | 1.5 story | Rec room (rating): | |
| Style: | Residential O/S | Fin bsmt living area: | |
| Use: | Single family | First floor: | 1,080 SF |
| Exterior wall: | Wood | Second floor: | 576 SF |
| Masonry adjust: | | Third floor: | |
| Roof type: | Asphalt shingles | Finished attic: | |
| Heating: | Gas, hot water | Unfinished attic: | |
| Cooling: | No A/C | Unfinished area: | |
| Bedrooms: | 3 | Enclosed porch | 84 SF |
| Family rooms: | | Deck | 35 SF |
| Baths: | 2 full, 0 half | | |
| Other rooms: | 6 | | |
| Whirl / hot tubs: | | | |
| Add'l plumb fixt: | | | |
| Masonry FPs: | | | |
| Metal FPs: | | | |
| Gas only FPs: | | Grade: | C |
| Bsmt garage: | | Condition: | Average |
| Shed dormers: | | Energy adjustment: | No |
| Gable/hip dorm: | | Percent complete: | 100% |



Total living area is 1,656 SF; building assessed value is \$167,600

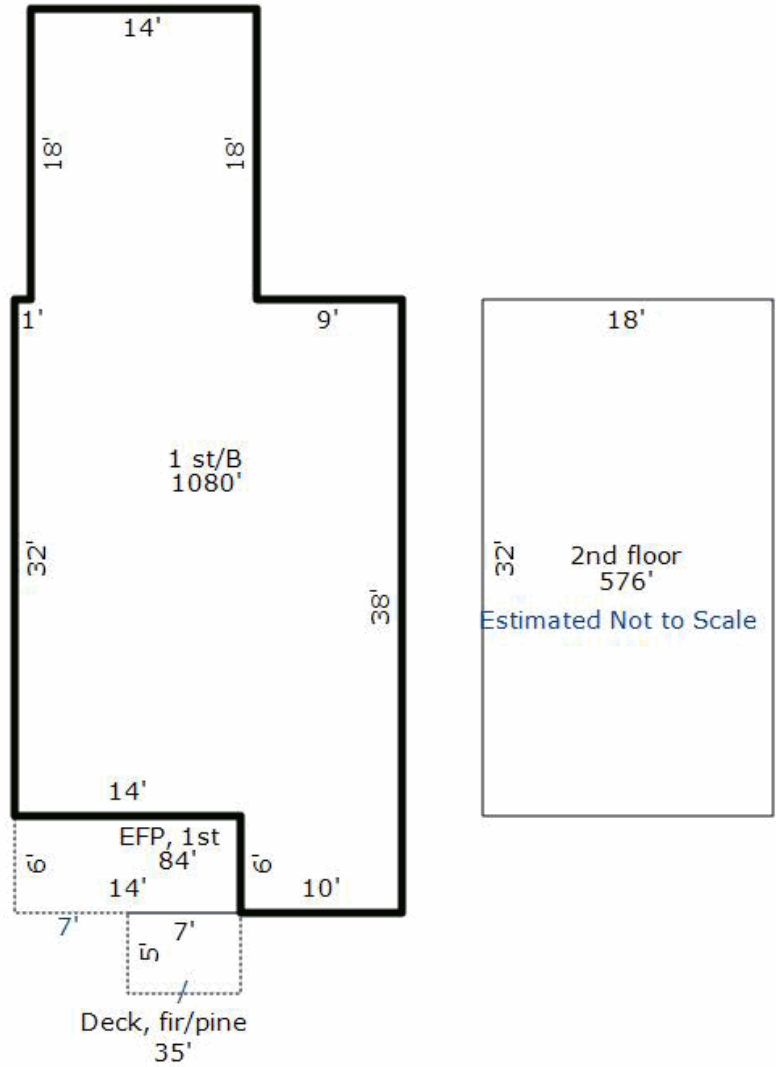

2025 Property Records for Village of Elkhart Lake, Sheboygan Country

February 20, 2026

| # of identical OBIs: 1 | | Other Building Improvement (OBI) | | |
|-----------------------------------|--------------------|----------------------------------|--|---------------|
| Main Structure | | Modifications (Type, Size) | | Photograph |
| OBI type: Garage | Width: 20 LF | Grade: C | | not available |
| Const type: Detached, frame or cb | Depth: 30 LF | Condition: Average | | |
| Year built: 1920 | Floor area: 600 SF | % complete: 100% | | |
| | | Assessed \$: \$3,900 | | |