

**2025 Assessment Year** **Village of Kohler, Sheboygan County (2025 Assessment Year)** **Property Records**



Current Owner
DAVID S & WENDY A BOLLAND LIVING T

Districts	
Sheboygan County	Sheboygan County
Kohler	Village of Kohler
School	2842 - Kohler
Voc/ Tech College	Vtech - 1100

General Information			
Parcel Number:	691083		
Alternate ID:	59141691083		
Neighborhood:	513 - Woodlands of Kohler Co		
Neighborhood Group:	Condominiums		
Sanitary	Sewer		
Traffic	Light		
Water	Muni water		

Total Acreage:	0.00
Total Sq. Ft:	0
Actual Frontage:	
Effective Frontage:	0
Effective Depth:	0
Water Influence:	None
Water Desirability:	None

*Legal Description		
THE WOODLANDS OF KOHLER, WISCONSIN CONDOMINIUM - UNIT 102 AND AN UNDIV INT IN THE COMMON, AND LIMITED COMMON ELEMENTS AS SET FORTH IN DECL #2149759.		
*This legal description may be abbreviated and is for assessment purposes only.		
Section:	30	Township: 15
Subdivision:		Range: 23E
		Block:
		Lot / Unit:

Inspection Data		
Date	User	Type

Property Sales / Ownership History						
Sale Date	Sale Price	Sale Typ	Validity	Document #	Deed Type	Grantor
12/1/2023	\$515,000		6 - Sale includes unfinished improvements	2158466	1 - Warranty	David S & Wendy A Bolland Living Trust

Summary of 2025 Assessment Year Values					
Tax Classification	Code	Acres	Land	Improvement	Total
Residential	1	0.000	\$65,000	\$366,000	\$431,000
<b>Total Real Estate - All Columns:</b>		<b>0.000</b>	<b>\$65,000</b>	<b>\$366,000</b>	<b>\$431,000</b>

Assessment Value History					
Year	Code	Acres	Land	Improvement	Total
2025	1	0.000	\$65,000	\$366,000	\$431,000
	<b>Totals</b>	<b>0.000</b>	<b>\$65,000</b>	<b>\$366,000</b>	<b>\$431,000</b>
2024	1	0.000	\$65,000	\$366,000	\$431,000
	<b>Totals</b>	<b>0.000</b>	<b>\$65,000</b>	<b>\$366,000</b>	<b>\$431,000</b>

Special Tax Programs (MFL/PFC) and Exempt					
Tax Classification	Code	Acres	Land	Improvement	Total

Permit Information				
Issued Date	Number	Amount	Status	Purpose/Description

**2025 Assessment Year**      **Village of Kohler, Sheboygan County (2025 Assessment Year)**      **Property Records**

Land Information										
Land Line	Tax Classification	MAR Subclass	Acres	Sq. Ft.	Width	Depth	Unit of Measure	Units	Unit Rate	Land Value
1	Residential		0.000	0	0	0	Buildable Unit	1.000	65000.00	\$65,000
<b>Total All Columns:</b>			<b>0.000</b>	<b>0</b>					<b>Total All Columns:</b>	<b>\$65,000</b>

Other Building Improvements (OBI)											
Bldg #	Tax Class	Style	Class/Const	Year Built	Grade	Condition	Width	Length	Height	Units	OBI Value
<b>Total Columns:</b>											

Extra Features (XF)												
XF #	Tax Class	Code	Alt. Description	Assoc. Bldg	Year Built	Grade	Condition	Width	Length	Height	Units	XF Value
<b>Total Columns:</b>												
											<b>\$</b>	

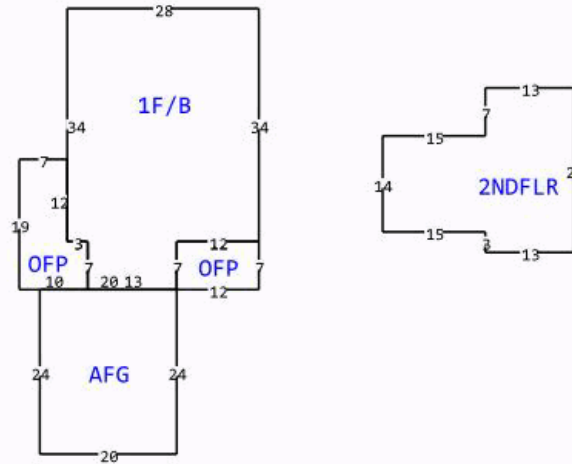

**Building Data**

Tax Classification	Residential	Additional Fixtures	NO
Building Number/Section	1 - 1	Hot Tub	NO
Building Style	Garden Condo	Plumbing Rough In	NO
Quality/Grade	B-	Family Rooms	NO
Year Built	2023	Other Rooms	NO
Effective Year Built	2023	Masonry Fireplace Stacks	NO
Class/Const	Frame	Masonry Fireplace Openings	NO
Overall Condition (CDU)	Excellent	Masonry Additional Stories	NO
Occupancy (Use)	Single Family	Metal Fireplace Stacks	NO
Living/Apartment Units	1	Metal Fireplace Openings	NO
Stories	2 story	Metal Additional Stories	NO
Roof Type	Asphalt shingles	Gas Fireplace Openings	NO
Basement Type	Not Specified	Equipment Rating	Excellent
Exterior Wall	Cement fiber board	Kitchen Rating	Excellent
Masonry Adjustment SF	0	Bath Rating	Excellent
Shed Dormer LF	0	Interior Rating	Excellent
Gable Dormer LF	0	Exterior Rating	Excellent
Heating	Gas, forced air	Rec Room Rating	Average
Air Conditioning	A/C (same ducts)		
Bedrooms	3		
Bath-Full	2		
Bath-Half	1		
Whirlpool	0		

**Building Area**

Living Area	Sq. Ft.	Other Area	Sq. Ft.	Attachment Area	Sq. Ft.
First Floor Area	1,043	Unfinished Attic Area	0	Attached garage, frame	480
Second Floor Area	522	Unfinished Area	0	Open frame porch, first floor	238
Third Floor Area	0	Basement Area	1,043		
Half Floor Area	0	Crawlspace Area	0		
Finished Attic Area	0	Finished Basement Area (FBLA)	0		
		Rec Room Area	0		
<b>Total Above Grade Living Area</b>	<b>1,565</b>	<b>Total Sq. Ft. Living Area (SFLA)</b>	<b>1,565</b>		