

2025 Assessment Year

City of Sheboygan Falls, Sheboygan County (2025 Assessment Year)

Property Records



Current Owner
LAKEVIEW HOMES LLC

Districts	
Sheboygan County	Sheboygan County
Sheboygan Falls	City of Sheboygan Falls
School	School 5278
Voc/ Tech College	Vtech 1100

General Information			
Parcel Number:	912450		
Alternate ID:	59282912450		
Neighborhood:	Duplex & Triplex - Pre-WWII		
Neighborhood Group:	Duplex & Triplex		
Sanitary	Sewer		
Traffic	Light		
Water	City water		

Total Acreage:	0.13
Total Sq. Ft:	5,663
Actual Frontage:	
Effective Frontage:	56
Effective Depth:	100
Water Influence:	None
Water Desirability:	None

*Legal Description		
HILLCREST LOT 2		
*This legal description may be abbreviated and is for assessment purposes only.		
Section:	Township:	Range:
Subdivision:	Block:	Lot / Unit:

Inspection Data		
Date	User	Type

Property Sales / Ownership History						
Sale Date	Sale Price	Sale Typ	Validity	Document #	Deed Type	Grantor
2/12/2021	\$125,000	IMPROVED	2 - Valid improved sale	2109473	1 - Warranty	MOE Properties, LLC

Summary of 2025 Assessment Year Values					
Tax Classification	Code	Acres	Land	Improvement	Total
Residential	1	0.130	\$22,500	\$149,500	\$172,000
Total Real Estate - All Columns:		0.130	\$22,500	\$149,500	\$172,000

Assessment Value History					
Year	Code	Acres	Land	Improvement	Total
2025	1	0.130	\$22,500	\$149,500	\$172,000
	Totals	0.130	\$22,500	\$149,500	\$172,000
2024	1	0.130	\$22,500	\$149,500	\$172,000
	Totals	0.130	\$22,500	\$149,500	\$172,000
2023	1	0.130	\$20,000	\$95,900	\$115,900
	Totals	0.130	\$20,000	\$95,900	\$115,900

Special Tax Programs (MFL/PFC) and Exempt					
Tax Classification	Code	Acres	Land	Improvement	Total

Permit Information				
Issued Date	Number	Amount	Status	Purpose/Description
2022-09-27		\$ 0	Completed	Service Upgrade
2004-07-06	9086	\$ 20000	Completed	Replace siding & windows

Land Information										
Land Line	Tax Classification	MAR Subclass	Acres	Sq. Ft.	Width	Depth	Unit of Measure	Units	Unit Rate	Land Value
1	Residential		0.130	5,663	56	100	Square Feet	5,663.000	4.00	\$22,500
Total All Columns:			0.130	5,663						\$22,500

Other Building Improvements (OBI)											
Bldg #	Tax Class	Style	Class/Const	Year Built	Grade	Condition	Width	Length	Height	Units	OBI Value
Total Columns:											

Extra Features (XF)												
XF #	Tax Class	Code	Alt. Description	Assoc. Bldg	Year Built	Grade	Condition	Width	Length	Height	Units	XF Value
Total Columns:												
											\$	

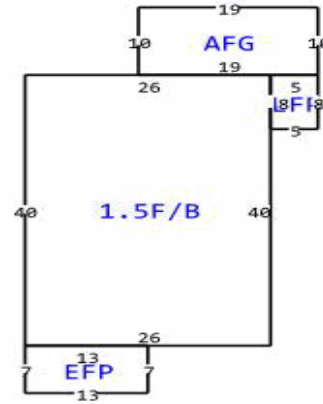

Building Data			
Tax Classification	Residential	Additional Fixtures	2
Building Number/Section	1 - 1	Hot Tub	0
Building Style	Duplex Flat	Plumbing Rough In	0
Quality/Grade	C+	Family Rooms	0
Year Built	1920	Other Rooms	5
Effective Year Built	1920	Masonry Fireplace Stacks	0
Class/Const	Frame	Masonry Fireplace Openings	0
Overall Condition (CDU)	Average	Masonry Additional Stories	0
Occupancy (Use)	2 Family	Metal Fireplace Stacks	0
Living/Apartment Units	2	Metal Fireplace Openings	0
Stories	1.5 story	Metal Additional Stories	0
Roof Type	Asphalt shingles	Gas Fireplace Openings	0
Basement Type	Not Specified	Equipment Rating	Good
Exterior Wall	Alum/vinyl	Kitchen Rating	Fair
Masonry Adjustment SF	0	Bath Rating	Average
Shed Dormer LF	28	Interior Rating	Average
Gable Dormer LF	0	Exterior Rating	Good
Heating	Gas, forced air	Rec Room Rating	No Code
Air Conditioning	No A/C		
Bedrooms	4		
Bath-Full	2		
Bath-Half	0		
Whirlpool	0		

Building Area					
Living Area	Sq. Ft.	Other Area	Sq. Ft.	Attachment Area	Sq. Ft.
First Floor Area	1,040	Unfinished Attic Area	0	Attached garage, frame	190
Second Floor Area	0	Unfinished Area	0	Enclosed frame porch, first floor	131
Third Floor Area	0	Basement Area	1,040		
Half Floor Area	780	Crawlspace Area	0		
Finished Attic Area	0	Finished Basement Area (FBLA)	0		
		Rec Room Area	0		
Total Above Grade Living Area	1,820	Total Sq. Ft. Living Area (SFLA)	1,820		