

2025 Property Records for Town of Schleswig, Manitowoc County

March 17, 2026

Tax key number: 016-505-000-004.00

Property address: 14025 Cedar Ter Rd

Traffic / water / sanitary: Medium / Well water / Septic/Mound

Summary of Assessment	
Land	\$369,000
Improvements	\$734,400
Total value	\$1,103,400

Land									
Qty	Land Use	Width	Depth	Square Feet	Acres	Water Frontage	Tax Class	Special Tax Program	Assess Value
1	Residential	125	145			Lake (Prime)	Residential		\$369,000

Residential Building			
Year built:	1988	Full basement:	676 SF
Stories:	2 story	Crawl space:	
Style:	Contemporary	Rec room (rating):	
Use:	Single family	Fin bsmt living area:	
Exterior wall:	Wood	First floor:	1,152 SF
Masonry adjust:		Second floor:	760 SF
Roof type:	Asphalt shingles	Finished attic:	1,274 SF
Heat type:	A/C	Unfinished attic:	
Fuel type:	Gas	Unfinished area:	
System type:	Warm air	Patio	132 SF
Bedrooms:	3	Open porch	164 SF
Family rooms:	2	Screen porch	255 SF
Full baths:	4	Deck	624 SF
Half baths:	1	Garage	1,116 SF
Other rooms:	4		
FP stacks:	2		
FP openings:	2		
Metal FPs:		Grade:	A-
Bsmnt garage:		Condition:	Good
		% complete:	100%



Total living area is 3,186 SF; building assessed value is \$721,500

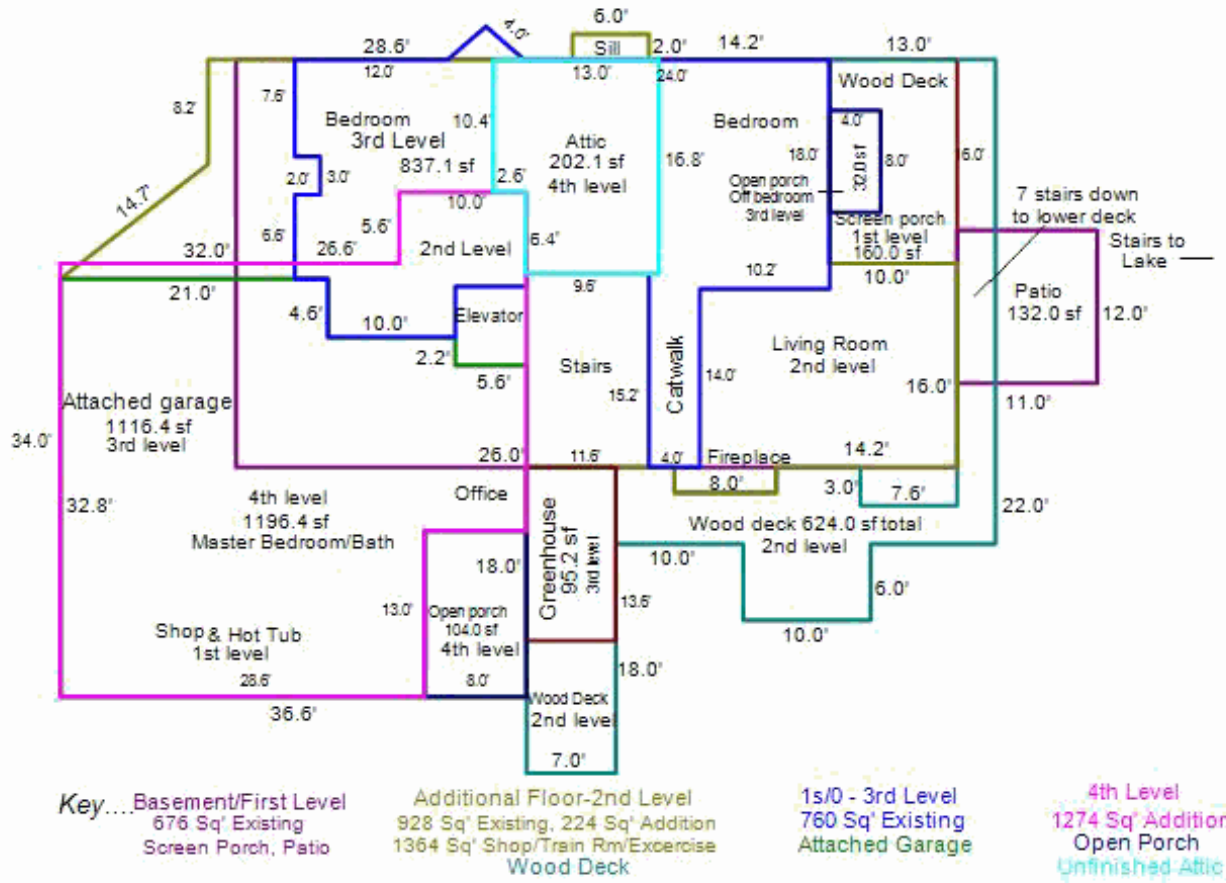

2025 Property Records for Town of Schleswig, Manitowoc County

March 17, 2026

# of identical OBIs: 1		Other Building Improvement (OBI)		
Main Structure		Modifications (Type, Size)		Photograph
OBI type: Well & Septic/Mound Const type: std construction Year built:	Width: 1 LF Depth: 1 LF Floor area: 1 SF	Grade: C Condition: % complete: 100% Assessed \$: \$12,900		not available

Building Permits				
Issued	Permit #	Purpose	\$ Amount	Completed
2/16/2009	2009-004	Addition/remodel	\$450,000	12/31/2012

Sales History		
Date	Price	Type
12/4/2020	\$850,000	Valid improved sale