

**2026 Assessment Year** **City of Sheboygan Falls, Sheboygan County (2026 Assessment Year)** **Property Records**



Current Owner
CHERYL L DRISCOLL

Districts	
Sheboygan County	Sheboygan County
Sheboygan Falls	City of Sheboygan Falls
School	School 5278
Voc/Tech College	Vtech 1100

General Information			
Parcel Number:	925582		
Alternate ID:	59282925582		
Neighborhood:	Milev's Meadows Condos		
Neighborhood Group:	Condos		
Sanitary	Sewer		
Traffic	Light		
Water	City water		

Total Acreage:	0.00
Total Sq. Ft:	0
Actual Frontage:	
Effective Frontage:	0
Effective Depth:	0
Water Influence:	None
Water Desirability:	None

*Legal Description		
MILEY'S MEADOW CONDOMINIUM - UNIT 12 AND AN UNDIV INT IN COMMON & LIMITED COMMON ELEMENTS AS SET FORTH IN #1814802 & AOC #1880904 & AOC #1972596		
*This legal description may be abbreviated and is for assessment purposes only.		
Section:	Township:	Range:
Subdivision:	Block:	Lot / Unit:

Inspection Data		
Date	User	Type

Property Sales / Ownership History						
Sale Date	Sale Price	Sale Typ	Validity	Document #	Deed Type	Grantor
6/6/2024	\$279,000	IMPROVED	2 - Valid improved sale	2165140	1 - Warranty	Leick Rogene M

Summary of 2026 Assessment Year Values					
Tax Classification	Code	Acres	Land	Improvement	Total
Residential	1	0.000	\$30,000	\$262,000	\$292,000
<b>Total Real Estate - All Columns:</b>		<b>0.000</b>	<b>\$30,000</b>	<b>\$262,000</b>	<b>\$292,000</b>

Assessment Value History					
Year	Code	Acres	Land	Improvement	Total
2025	1	0.000	\$30,000	\$262,000	\$292,000
	<b>Totals</b>	<b>0.000</b>	<b>\$30,000</b>	<b>\$262,000</b>	<b>\$292,000</b>
2024	1	0.000	\$30,000	\$262,000	\$292,000
	<b>Totals</b>	<b>0.000</b>	<b>\$30,000</b>	<b>\$262,000</b>	<b>\$292,000</b>
2023	1	0.000	\$28,000	\$130,500	\$158,500
	<b>Totals</b>	<b>0.000</b>	<b>\$28,000</b>	<b>\$130,500</b>	<b>\$158,500</b>

Special Tax Programs (MFL/PFC) and Exempt					
Tax Classification	Code	Acres	Land	Improvement	Total

Permit Information				
Issued Date	Number	Amount	Status	Purpose/Description



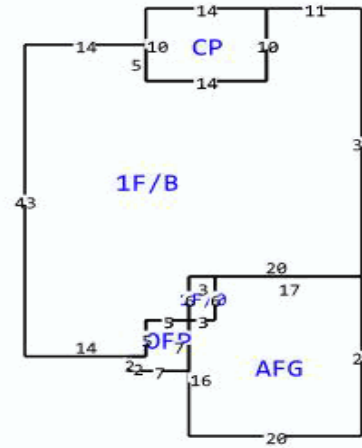

**Building Data**

Tax Classification	Residential	Additional Fixtures	1
Building Number/Section	1 - 1	Hot Tub	0
Building Style	Garden Condo	Plumbing Rough In	0
Quality/Grade	C+	Family Rooms	0
Year Built	2006	Other Rooms	4
Effective Year Built	2006	Masonry Fireplace Stacks	0
Class/Const	Frame	Masonry Fireplace Openings	0
Overall Condition (CDU)	Average	Masonry Additional Stories	0
Occupancy (Use)	Condominium	Metal Fireplace Stacks	0
Living/Apartment Units	1	Metal Fireplace Openings	0
Stories	1 story	Metal Additional Stories	0
Roof Type	Asphalt shingles	Gas Fireplace Openings	1
Basement Type	Not Specified	Equipment Rating	Average
Exterior Wall	Alum/vinyl	Kitchen Rating	Average
Masonry Adjustment SF	70	Bath Rating	Average
Shed Dormer LF	0	Interior Rating	Average
Gable Dormer LF	8	Exterior Rating	Average
Heating	Gas, forced air	Rec Room Rating	Average
Air Conditioning	A/C, same ducts		
Bedrooms	2		
Bath-Full	2		
Bath-Half	0		
Whirlpool	0		

**Building Area**

Living Area	Sq. Ft.	Other Area	Sq. Ft.	Attachment Area	Sq. Ft.
First Floor Area	1,435	Unfinished Attic Area	0	Attached garage, frame	422
Second Floor Area	0	Unfinished Area	0	Concrete patio	140
Third Floor Area	0	Basement Area	1,417	Open frame porch, first floor	39
Half Floor Area	0	Crawlspace Area	0		
Finished Attic Area	0	Finished Basement Area (FBLA)	0		
		Rec Room Area	0		
<b>Total Above Grade Living Area</b>	<b>1,435</b>	<b>Total Sq. Ft. Living Area (SFLA)</b>	<b>1,435</b>		