

**2026 Assessment Year** **City of Sheboygan Falls, Sheboygan County (2026 Assessment Year)** **Property Records**



Current Owner	
LOREN R KAPELKA	

Districts	
Sheboygan County	Sheboygan County
Sheboygan Falls	City of Sheboygan Falls
School	School 5278
Voc/ Tech College	Vtech 1100

General Information			
Parcel Number:	919703		
Alternate ID:	59282919703		
Neighborhood:	Westwynde Bluffs Subd		
Neighborhood Group:	2000's Subdivisions		
Sanitary	Sewer		
Traffic	Light		
Water	City water		

Total Acreage:	0.31
Total Sq. Ft:	13,504
Actual Frontage:	
Effective Frontage:	90
Effective Depth:	150
Water Influence:	None
Water Desirability:	None

*Legal Description		
WESTWYNDE BLUFFS SUBD. LOT 2		
*This legal description may be abbreviated and is for assessment purposes only.		
Section:	Township:	Range:
Subdivision:	Block:	Lot / Unit:

Inspection Data		
Date	User	Type

Property Sales / Ownership History						
Sale Date	Sale Price	Sale Typ	Validity	Document #	Deed Type	Grantor

Summary of 2026 Assessment Year Values					
Tax Classification	Code	Acres	Land	Improvement	Total
Residential	1	0.310	\$45,500	\$320,300	\$365,800
<b>Total Real Estate - All Columns:</b>		<b>0.310</b>	<b>\$45,500</b>	<b>\$320,300</b>	<b>\$365,800</b>

Assessment Value History					
Year	Code	Acres	Land	Improvement	Total
2025	1	0.310	\$45,500	\$320,300	\$365,800
	<b>Totals</b>	<b>0.310</b>	<b>\$45,500</b>	<b>\$320,300</b>	<b>\$365,800</b>
2024	1	0.310	\$45,500	\$320,300	\$365,800
	<b>Totals</b>	<b>0.310</b>	<b>\$45,500</b>	<b>\$320,300</b>	<b>\$365,800</b>
2023	1	0.310	\$40,900	\$172,500	\$213,400
	<b>Totals</b>	<b>0.310</b>	<b>\$40,900</b>	<b>\$172,500</b>	<b>\$213,400</b>

Special Tax Programs (MFL/PFC) and Exempt					
Tax Classification	Code	Acres	Land	Improvement	Total

Permit Information				
Issued Date	Number	Amount	Status	Purpose/Description
2006-09-18	10084	\$ 177000	Completed	New home (Warner Homes)

Land Information										
Land Line	Tax Classification	MAR Subclass	Acres	Sq. Ft.	Width	Depth	Unit of Measure	Units	Unit Rate	Land Value
1	Residential		0.310	13,504	90	150	Square Feet	13,504.000	3.36	\$45,500
<b>Total All Columns:</b>			<b>0.310</b>	<b>13,504</b>					<b>Total All Columns:</b>	<b>\$45,500</b>

Other Building Improvements (OBI)											
Bldg #	Tax Class	Style	Class/Const	Year Built	Grade	Condition	Width	Length	Height	Units	OBI Value
2	Residential	Utility shed	Frame	2018	C	Good	10	17	0	170	2,300
<b>Total Columns:</b>										<b>2,300</b>	

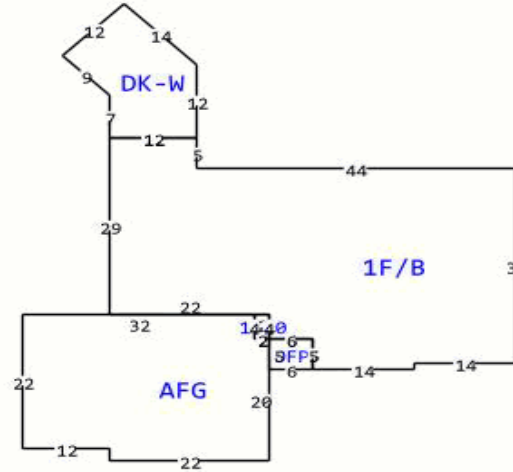

**Building Data**

Tax Classification	Residential	Additional Fixtures	1
Building Number/Section	1 - 1	Hot Tub	0
Building Style	Ranch	Plumbing Rough In	0
Quality/Grade	C+	Family Rooms	0
Year Built	2006	Other Rooms	4
Effective Year Built	2006	Masonry Fireplace Stacks	0
Class/Const	Frame	Masonry Fireplace Openings	0
Overall Condition (CDU)	Average	Masonry Additional Stories	0
Occupancy (Use)	Single family	Metal Fireplace Stacks	0
Living/Apartment Units	1	Metal Fireplace Openings	0
Stories	1 story	Metal Additional Stories	0
Roof Type	Asphalt shingles	Gas Fireplace Openings	1
Basement Type	Not Specified	Equipment Rating	Average
Exterior Wall	Alum/vinyl	Kitchen Rating	Average
Masonry Adjustment SF	110	Bath Rating	Average
Shed Dormer LF	0	Interior Rating	Average
Gable Dormer LF	0	Exterior Rating	Average
Heating	Gas, forced air	Rec Room Rating	No Code
Air Conditioning	A/C, same ducts		
Bedrooms	3		
Bath-Full	2		
Bath-Half	0		
Whirlpool	0		

**Building Area**

Living Area	Sq. Ft.	Other Area	Sq. Ft.	Attachment Area	Sq. Ft.
First Floor Area	1,674	Unfinished Attic Area	0	Attached garage, frame	784
Second Floor Area	0	Unfinished Area	0	Deck, wood	254
Third Floor Area	0	Basement Area	1,666	Open frame porch, first floor	30
Half Floor Area	0	Crawlspace Area	0		
Finished Attic Area	0	Finished Basement Area (FBLA)	0		
		Rec Room Area	0		
<b>Total Above Grade Living Area</b>	<b>1,674</b>	<b>Total Sq. Ft. Living Area (SFLA)</b>	<b>1,674</b>		