

**2026 Assessment Year** **Town of Lima, Sheboygan County (2026 Assessment Year)** **Property Records**



Current Owner
EMILY B LEROY

Districts	
Sheboygan County	Sheboygan County
Lima	Town of Lima
School	School 5278 - Sheb Falls
Voc/ Tech College	Vtech School 1100

General Information			
Parcel Number:	59008094551		
Alternate ID:	59008094551		
Neighborhood:	103 - Residential - River/Wooc		
Neighborhood Group:	1 - Residential		
Sanitary	Septic		
Traffic	Medium		
Water	Well water		

Total Acreage:	1.89
Total Sq. Ft:	82,328
Actual Frontage:	
Effective Frontage:	0
Effective Depth:	0
Water Influence:	River Frontage
Water Desirability:	Primary

*Legal Description		
LOT 2 CSM V18 P 216-17 #1632395 - PRT SW NW & NW SW SEC 12 & ALSO PRT LOT 1 SD CSM DESC IN #1899799.		
*This legal description may be abbreviated and is for assessment purposes only.		
Section:	12	Township: 14
Subdivision:		Range: 22E
		Block:
		Lot / Unit:

Inspection Data		
Date	User	Type

Property Sales / Ownership History						
Sale Date	Sale Price	Sale Typ	Validity	Document #	Deed Type	Grantor
3/22/2021	\$540,000		5 - Not a market sale	2111600	1 - Warranty	Hertel Robert W
2/5/2021	\$540,000	IMPROVED	2 - Valid improved sale	2108684	1 - Warranty	Hertel Pamela K
4/19/2010	\$16,000	VACANT	1 - Valid vacant sale	1899799	1 - Warranty	Kretschmann Eugene A

Summary of 2026 Assessment Year Values					
Tax Classification	Code	Acres	Land	Improvement	Total
Residential	1	1.890	\$82,300	\$483,500	\$565,800
<b>Total Real Estate - All Columns:</b>		<b>1.890</b>	<b>\$82,300</b>	<b>\$483,500</b>	<b>\$565,800</b>

Assessment Value History					
Year	Code	Acres	Land	Improvement	Total
2025	1	1.890	\$82,300	\$483,500	\$565,800
	<b>Totals</b>	<b>1.890</b>	<b>\$82,300</b>	<b>\$483,500</b>	<b>\$565,800</b>
2024	1	1.890	\$82,300	\$483,500	\$565,800
	<b>Totals</b>	<b>1.890</b>	<b>\$82,300</b>	<b>\$483,500</b>	<b>\$565,800</b>
2023	1	1.890	\$82,300	\$483,500	\$565,800
	<b>Totals</b>	<b>1.890</b>	<b>\$82,300</b>	<b>\$483,500</b>	<b>\$565,800</b>

Special Tax Programs (MFL/PFC) and Exempt					
Tax Classification	Code	Acres	Land	Improvement	Total

Permit Information				
Issued Date	Number	Amount	Status	Purpose/Description

**2026 Assessment Year** **Town of Lima, Sheboygan County (2026 Assessment Year)** **Property Records**

Land Information										
Land Line	Tax Classification	MAR Subclass	Acres	Sq. Ft.	Width	Depth	Unit of Measure	Units	Unit Rate	Land Value
1	Residential		1.890	82,328	0	0	Acreage	1.890	43518.52	\$82,300
<b>Total All Columns:</b>			<b>1.890</b>	<b>82,328</b>					<b>Total All Columns:</b>	<b>\$82,300</b>

Other Building Improvements (OBI)											
Bldg #	Tax Class	Style	Class/Const	Year Built	Grade	Condition	Width	Length	Height	Units	OBI Value
<b>Total Columns:</b>											

Extra Features (XF)												
XF #	Tax Class	Code	Alt. Description	Assoc. Bldg	Year Built	Grade	Condition	Width	Length	Height	Units	XF Value
1	Residential	Well, drilled			0	C	Average	0	0	0	1	\$2,500
2	Residential	Septic, conventional			0	C	Average	0	0	0	1	\$2,500
3	Residential	Open Framed Porch (SF)			2016	C	Average	10	10	0	100	\$1,100
<b>Total Columns:</b>											<b>\$6,100</b>	

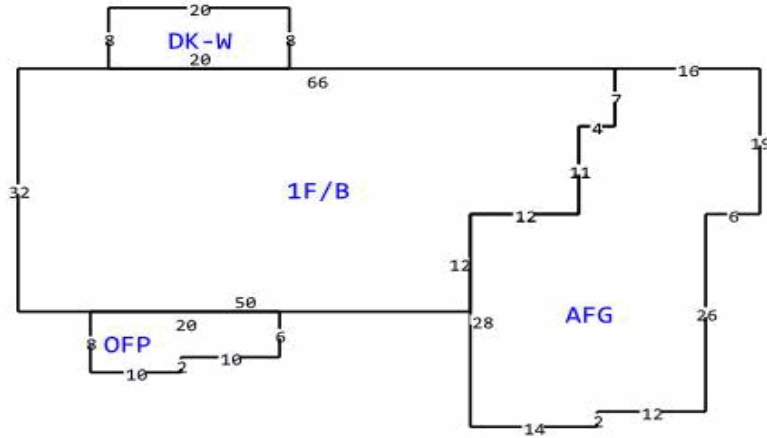

**Building Data**

Tax Classification	Residential	Additional Fixtures	5
Building Number/Section	1 - 1	Hot Tub	0
Building Style	Ranch	Plumbing Rough In	0
Quality/Grade	B-	Family Rooms	1
Year Built	2006	Other Rooms	0
Effective Year Built	2006	Masonry Fireplace Stacks	0
Class/Const	Frame	Masonry Fireplace Openings	0
Overall Condition (CDU)	Average	Masonry Additional Stories	0
Occupancy (Use)	Single Family	Metal Fireplace Stacks	0
Living/Apartment Units	1	Metal Fireplace Openings	0
Stories	1 story	Metal Additional Stories	0
Roof Type	Asphalt shingles	Gas Fireplace Openings	1
Basement Type	Not Specified	Equipment Rating	Average
Exterior Wall	Masonite	Kitchen Rating	Average
Masonry Adjustment SF	280	Bath Rating	Average
Shed Dormer LF	0	Interior Rating	Average
Gable Dormer LF	0	Exterior Rating	Average
Heating	Gas, forced air	Rec Room Rating	No Code
Air Conditioning	A/C (same ducts)	Additional Kitchen (each)	1
Bedrooms	3	Wet or Dry Bar (each)	1
Bath-Full	3		
Bath-Half	1		
Whirlpool	1		

**Building Area**

Living Area	Sq. Ft.	Other Area	Sq. Ft.	Attachment Area	Sq. Ft.
First Floor Area	1,860	Unfinished Attic Area	0	Attached garage, frame	1,057
Second Floor Area	0	Unfinished Area	0	Deck, wood	160
Third Floor Area	0	Basement Area	1,860	Open frame porch, first floor	146
Half Floor Area	0	Crawlspace Area	0		
Finished Attic Area	0	Finished Basement Area (FBLA)	1,675		
		Rec Room Area	0		
<b>Total Above Grade Living Area</b>	<b>1,860</b>	<b>Total Sq. Ft. Living Area (SFLA)</b>	<b>3,535</b>		